

Notice of Making

THE FLINTSHIRE COUNTY COUNCIL

PRINCE OF WALES AVENUE, PARK AVENUE, ST CATHERINES CLOSE AND ALLT GOCH, FLINT

PROHIBITION OF WAITING AND WAITING AT ANY TIME RESTRICTIONS

Notice is hereby given that on the 20th June 2023, Flintshire County Council made an Order in exercise of its powers under the Road Traffic Regulation Act 1984, the Traffic Management Act 2004, Part IV of Schedule 9 and all other enabling powers, the effect of which will be to amend The Flintshire County Council (Prohibition and Restriction of Waiting and Loading and Parking Places) (Civil Enforcement and Consolidation) Order 2013, so as to introduce:-

1. 'No Waiting At Any Time' restrictions:-
 - a. At various locations on both sides of Prince of Wales Avenue, Flint
 - b. At various locations on both sides of Allt Goch, Flint
 - c. At the junction of Prince of Wales Avenue with Park Avenue, Flint
 - d. At the junction of Allt Goch with St Catherines Close, Flint
2. 'No Waiting Monday – Friday 8.30am – 9.30am and 2.30pm – 4.00pm' restrictions:
 - a. At various locations on both sides of Allt Goch, Flint
3. No Stopping on School Keep Clear Markings - Monday- Friday 8am – 5pm restriction.
 - a. On Allt Goch, Flint

In all other respects the present provisions of the 'The Flintshire County Council (Prohibition and Restriction of Waiting and Loading and Parking Places) (Civil Enforcement and Consolidation) Order 2013' will remain in force.

Should you wish to view a copy of this Notice, the Order which will come into operation on the 30th June 2023, plans showing the roads affected and a statement of the Council's reasons for the making of the Order, they may be inspected during normal opening hours at Flint Connects Centre Church Street, Flint, CH6 5BD. The documents will also be available to viewed on our website at www.Flintshire.gov.uk > Resident > Roads, Streets and Travel > Traffic Regulation Orders or you can request a copy of the documents by emailing Streetscene@flintshire.gov.uk or by calling 01352701234.

If you wish to question the validity of the Order or any of its provisions on the grounds that any requirements of the Act or any instruments made under it has not been complied with, you may, within 6 weeks from the date on which the Order is made, apply for the purpose to the High Court.

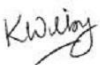

Katie Wilby, Chief Officer (Streetscene and Transportation), County Hall, Mold, Flintshire. CH7 6NR. Friday 23rd June 2023

THE FLINTSHIRE COUNTY COUNCIL
PRINCE OF WALES AVENUE, PARK AVENUE, ST CATHERINES
CLOSE AND ALLT GOCH, FLINT
(PROHIBITION AND RESTRICTION OF WAITING
AND LOADING AND PARKING PLACES)
(CIVIL ENFORCEMENT AND CONSOLIDATION) (AMENDMENT
NO. 54) ORDER 2023

Katie Wilby,
Chief Officer (Streetscene & Transportation),
County Hall,
Mold,
Flintshire,
CH7 6NF

THE FLINTSHIRE COUNTY COUNCIL
PRINCE OF WALES AVENUE, PARK AVENUE, ST CATHERINES CLOSE AND ALLT
GOCH, FLINT

(PROHIBITION AND RESTRICTION OF WAITING
AND LOADING AND PARKING PLACES)

(CIVIL ENFORCEMENT AND CONSOLIDATION) (AMENDMENT NO.54) ORDER 2023

Flintshire County Council in exercise of its powers under sections 1 (1), 2 (1)(2), 4 (2)(3) and Part IV of Schedule 9 of the Road Traffic Regulation Act 1984 (“the Act of 1984”) as amended, the Traffic Management Act 2004 (“the 2004 Act”) and of all other enabling powers and after consultation with the Chief Officer of Police in accordance with Part III of Schedule 9 to the Act of 1984, hereby makes the following Order:-

SECTION 1 – PRELIMINARY

Citation and commencement

1. This Order shall come into operation on the 30th June 2023 and may be cited as The Flintshire County Council, PRINCE OF WALES AVENUE, PARK AVENUE, ST CATHERINES CLOSE AND ALLT GOCH, FLINT (Prohibition and Restriction of Waiting and Loading and Parking Places) (Civil Enforcement and Consolidation) (Amendment No. 54) Order 2023
2. With effect from the date set out in Article 1 above, Map Schedule AL59 Sheet Revision No: 5 replaces Map Schedule AL59 Sheet Revision 4 and Map Schedule AL60, Sheet Revision No: 3, replaces Map Schedules AL60 Sheet Revision No: 2 and all other map schedules together with the before mentioned map schedules and plans referred to in the Schedules to this Order are incorporated into The Flintshire County Council (Prohibition and Restriction of Waiting and Loading and Parking Places) (Civil Enforcement and Consolidation) Order 2013.
3. The interpretation Act 1978 shall apply for the interpretation on this Order as it applies for the interpretation of an Act of Parliament
4. In this Order, except where otherwise stated, any reference to a numbered Article or Schedule is a reference to the Article or Schedule bearing that number and any reference to a plan is reference to a plan incorporated into this order.

SCHEDULE 1
No Waiting At Any Time
Flint

Road Name	Map Schedule	Sheet Revision
Prince of Wales Avenue	AL59	5 (which revokes revision Sheet 4 from the 2013 Order)
Park Avenue	AL59	5 (which revokes revision Sheet 4 from the 2013 Order)
Allt Goch	AL59	5 (which revokes revision Sheet 4 from the 2013 Order)
	AL60	3 (which revokes revision Sheet 2 from the 2013 Order)

SCHEDULE 2

No Waiting (Monday- Friday 8.30 – 9.30am – 2.30pm – 4.00pm)

Flint

Road Name	Map Schedule	Sheet Revision
Allt Goch	AL60	3 (which revokes revision Sheet 2 from the 2013 Order)
Prince of Wales Avenue	AL59	5 (which revokes revision Sheet 4 from the 2013 Order)

SCHEDULE 3

No Stopping on School Keep Clear Markings- Monday- Friday 8am – 5pm

Flint

Road Name	Map Schedule	Sheet Revision
Allt Goch	AL60	3 (which revokes revision Sheet 2 from the 2013 Order)

THE COMMON SEAL of)
FLINTSHIRE COUNTY COUNCIL)
was hereunto affixed)
this 20th day of June 2023)
in the presence of:-)



CHAIRMAN

LEGAL SERVICES MANAGER
~~CHIEF OFFICER (GOVERNANCE)~~
SENIOR SOLICITOR

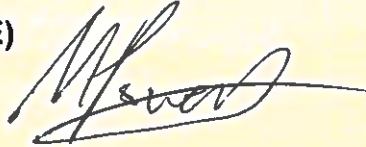

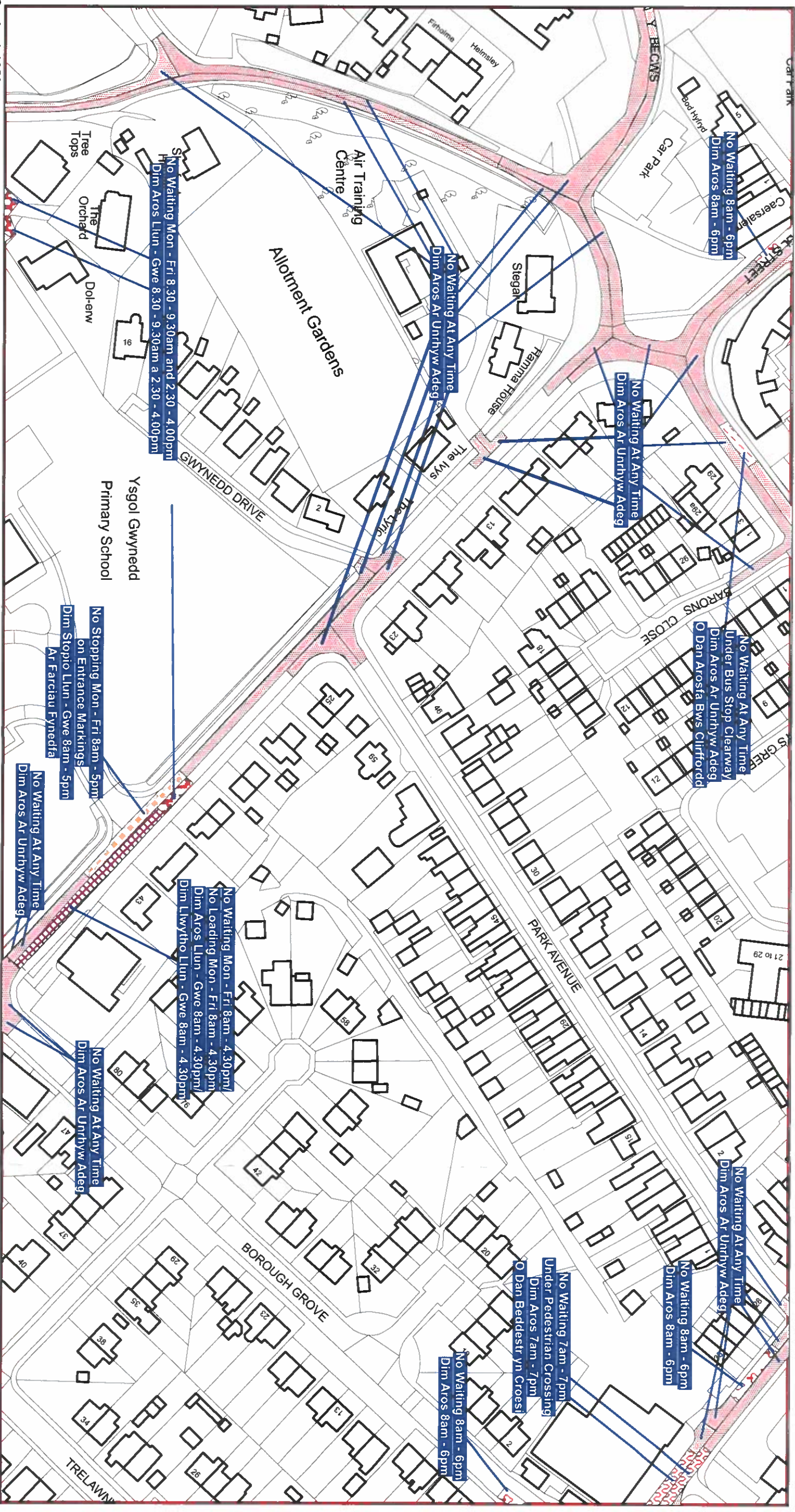

Scale: 1:1250
 Graddfa: 1:1250

This map is reproduced from Ordnance Survey material with the permission of Ordnance Survey on behalf of the Controller of Her Majesty's Stationary Office © Crown Copyright. Unauthorised reproduction infringes Crown Copyright and may lead to prosecution or civil proceedings. Licence No. 100023396

Agybrychir y map hwn o ddeunydd yr Ordnance Survey gyda chaniatâd yr Ordnance Survey ar ran Rheolwr Llyfrau Ei Mawrthyd!
 @Hawffraint y Goron. Mae agybrychirchu heb ganiatâd yn torri hawffraint y Goron a gall hyn arwain at erlyniad neu achos sifil.
 Rhif lwydded 100023396

The Flintshire County Council
(Prohibition and Restriction of Waiting and Loading and Parking Places)
(Civil Enforcement and Consolidation) (Amendment 54) Order 2023

Gorchymyn Cyngor Sir Y Fflint
(Gwahardd a Chyfyngu Aros a Llwytho a Mannau Parcio)
(Gorfodi Sifil a Chyddyfnërthu) (Gwelliant 54) 2023

Flintshire County Council
 Environment Directorate
 County Hall
 Mold
 CH7 6NF

Cyngor Sir Y Fflint
 Cyfarwyddiaeth yr Amgylchedd
 Neuadd Y Sir
 Yr Wyddgrug
 CH7 6NF

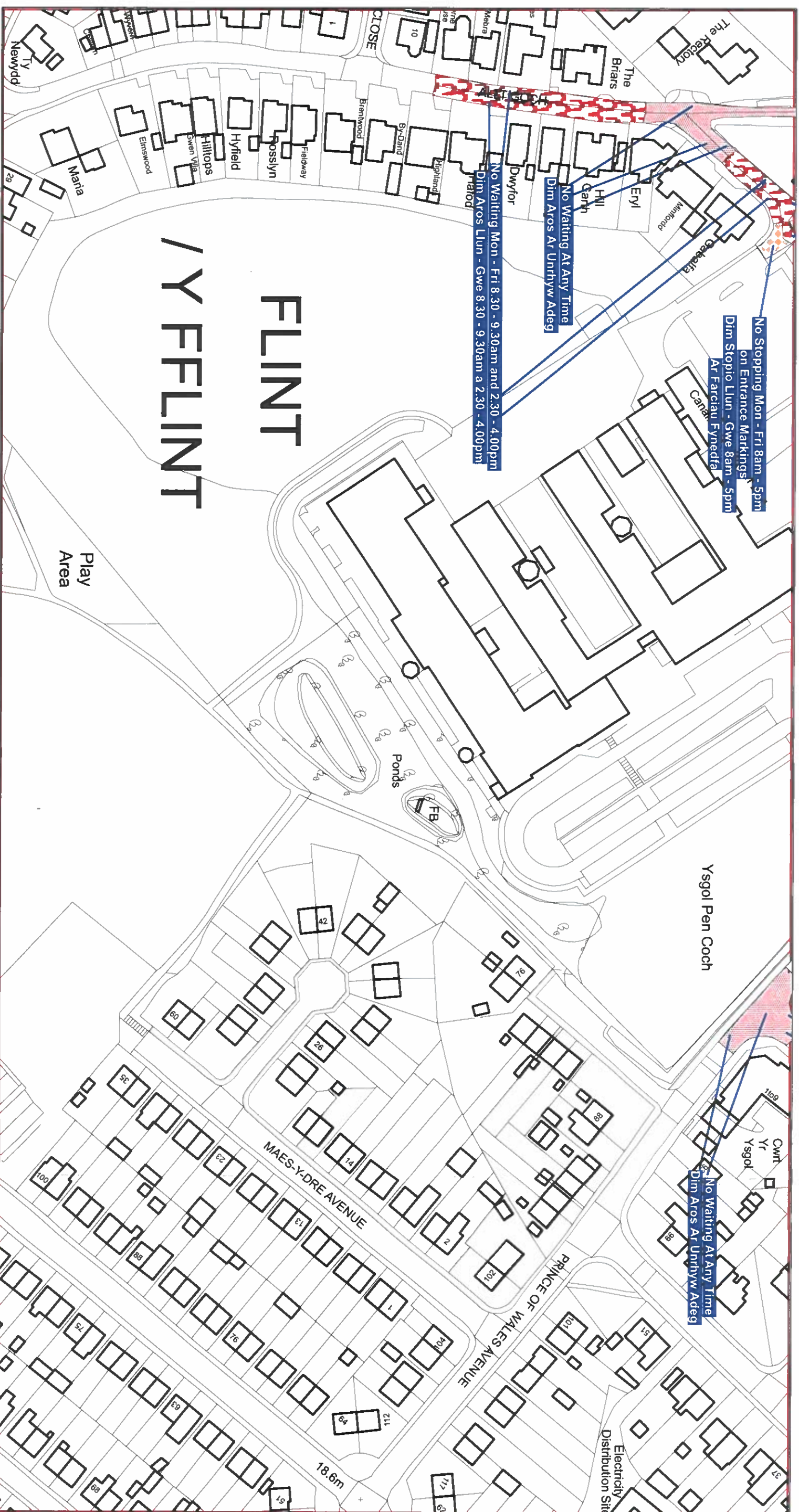

Scale: 1:1250
 Graddfa: 1:1250

This map is reproduced from Ordnance Survey material with the permission of Ordnance Survey on behalf of the Controller of Her Majesty's Stationary Office © Crown Copyright. Unauthorised reproduction infringes Crown Copyright and may lead to prosecution or civil proceedings. Licence No. 100023386

Agybnyrchir y map hwn o ddeunydd yr Ordnance Survey gyda chaniad yr Ordnance Survey ar ran Rheolwr Llyfrfa Ei Mawrhydi © Hawlfraint y Goron. Mae atgynhyrchu heb ganiadad yn torri hawlfraint y Goron a gall hyn arwain at erlyniad neu achos sifil. Rhif trwydded 100023386

The Flintshire County Council

(Prohibition and Restriction of Waiting and Loading and Parking Places)
(Civil Enforcement and Consolidation) (Amendment 54) Order 2023

Gorchymyn Cyngor Sir Y Fflint
(Gwahardd a Chyfyngu Aros a Llwytho a Mannau Parcio)
(Gorfodi Sifil a Chyddyfnerthu) (Gwelliant 54) 2023

Flintshire County Council
 Environment Directorate
 County Hall
 Mold
 CH7 6NF

Cyngor Sir Y Fflint
 Cyfarwyddiaeth yr Amgylchedd
 Neuadd Y Sir
 Yr Wyddgrug
 CH7 6NF

**PRINCE OF WALES AVENUE, PARK AVENUE, ST CATHERINES CLOSE AND
ALLT OCH, FLINT
PROPOSED PROHIBITION OF WAITING**

Statement of Reasons for Proposing to Make the Order

Flintshire County Council propose to introduce No Waiting at Any Time (double yellow lines) and Limited Waiting restrictions (single yellow line), in the roads as listed above.

The No Waiting At Any Time restrictions are intended to address indiscriminate parking, maintain visibility and to ensure that the junctions are not obstructed by parked vehicles.

Parking at junctions, regardless of the presence of yellow lines, is an offence and the restrictions provide a visual deterrent to reinforce this message. At present, should vehicles be parked within 10 metres of a junction, an act of criminality may be committed and would therefore be subject to enforcement action by North Wales Police. Furthermore the Highway Code states that vehicles should not park near or on a junction as they may cause obstruction and compromise safety for all road users.

The Introduction of the Limited Waiting restrictions, will improve pedestrian safety through the removal of parked vehicles at key locations, whilst reducing congestion and improving traffic flow around the School.

In the interests of road safety, the proposals are necessary to avoid danger to people or other traffic using the road, or preventing danger arising.

The proposals are detailed in the Public Notice and in the proposed Order

Dated this 18th day of November 2022



Katie Wilby,

Chief Officer (Streetscene & Transportation),
County Hall,
Mold,
Flintshire.
CH7 6NF

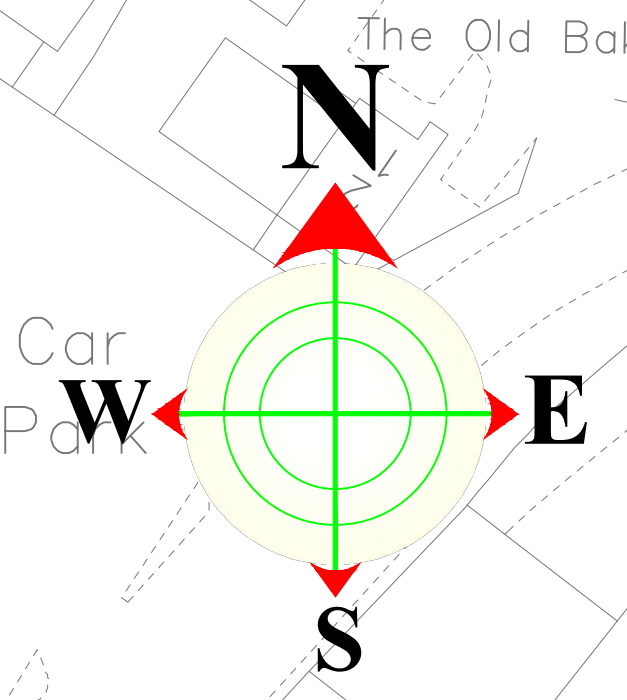

- KEY**
- Dim Aros Ar Unrhyw Adeg
No Waiting at Any Time
(Double Yellow Lines)
 - Dim Aros 'Llun Gwener 8.30am-9.30am
2.30pm-4.00pm
No Waiting Monday - Friday
8.30am-9.30am and 2.30pm-4.00pm)
 - Existing Lining to be Refreshed or renewed because of carriageway works.
 - Presenol Dim Ar Unrhyw Adeg
Existing No Waiting at Any Time
(Double Yellow Lines)

CONSTRUCT	WORKING	AS-BUILT

Sir y Fflint
Flintshire
 COUNTY COUNCIL
Streetscene

Ysgol Gwynedd
Flint
Area Location Plan
 (Sheet 1 of 1)

Flintshire County Council - Environment Directorate - County Hall 1, Mold CH7 6NF		
Contact Name: Claire Parry	Telephone: 01352 704529	
Drawn by: Nick Williams	Fax No: 01352 70	
Checked by: Claire Parry	Date: Feb 2022	Sheet 1 of 1
Scales at A0:	Drawing No:	Phase/Rev:
1:NTS	HT/23/0000/201	C1

This map is reproduced from Ordnance Survey material with the permission of Ordnance Survey on behalf of the Controller of Her Majesty's Stationery Office. © Crown Copyright. Unauthorised reproduction infringes Crown Copyright and may lead to prosecution or civil proceedings. Licence number: 100033386, Flintshire County Council, 2018.

School Keep Clear
If it can fit.