

Proposed Widening of Footway to be inline with adjacent footway with 10 x 5, 6 x 5 kerbs and Tarmac.

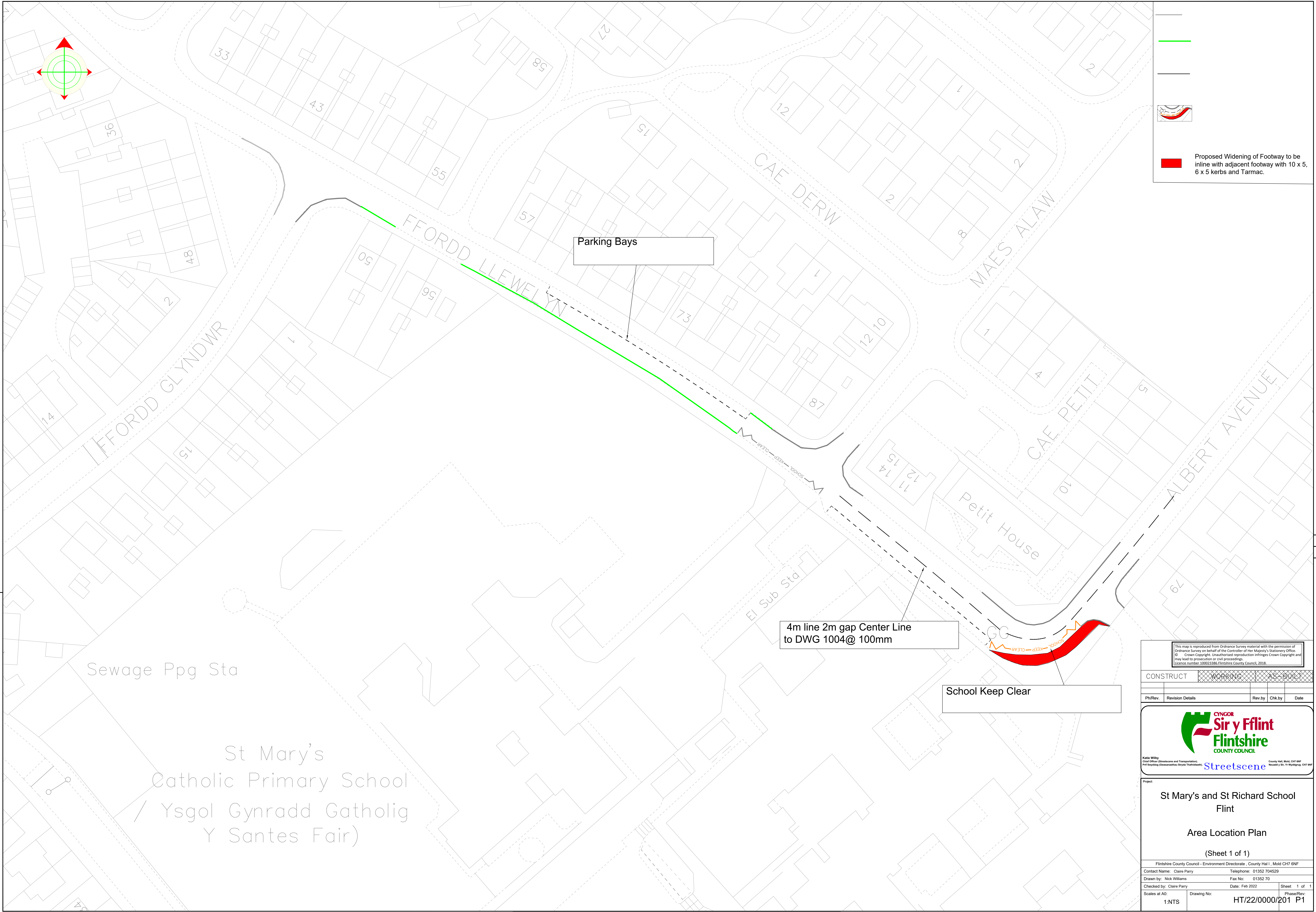

Parking Bays

4m line 2m gap Center Line to DWG 1004@ 100mm

School Keep Clear

Sewage Ppg Sta

St Mary's Catholic Primary School
Ysgol Gynradd Gatholig Y Santes Fair)

This map is reproduced from Ordnance Survey material with the permission of Ordnance Survey on behalf of the Controller of Her Majesty's Stationery Office. © Crown Copyright. Unauthorised reproduction infringes Crown Copyright and may lead to prosecution or civil proceedings. Licence number: 100023388, Flintshire County Council, 2018.

CONSTRUCT	WORKING	AS-BUILT
-----------	---------	----------

Ph/Rev	Revision Details	Rev by	Chk by	Date



Project			
St Mary's and St Richard School Flint			
Area Location Plan (Sheet 1 of 1)			
Flintshire County Council - Environment Directorate, County Hall 1, Mold CH7 6NF			
Contact Name: Claire Parry	Telephone: 01352 704529		
Drawn by: Nick Williams	Fax No: 01352 70		
Checked by: Claire Parry	Date: Feb 2022	Sheet 1 of 1	
Scales at A0: 1:NTS	Drawing No: HT/22/0000/201	Phase/Rev: P1	