

RHYBUDD O WNEUD

GORCHYMYN CYNGOR SIR Y FFLINT (GWAHANOL FFYRDD YN SIR Y FFLINT) (Terfyn Cyflymder 30 mya) 2023

Mae Cyngor Sir y Fflint yn rhoi rhybudd trwy hyn bod wedi gwneud wedi gwneud Gorchymyn ar 19 Medi 2023 drwy arfer ei bwerau dan Adran 84 Deddf Rheoleiddio Traffig Ffyrdd 1984, a phob grym galluogi arall a fydd yn:-

- a) Gosod cyfyngiad cyflymder o 30mya ar y darnau o ffordd a nodir yn yr Atodlenni i'r hysbysiad hwn.

ATODLEN 1 Terfyn Cyflymder 30mya YR WYDDGRUG

A541 FFORDD DINBYCH, YR WYDDGRUG: o bwynt 17 metr i'r gogledd-orllewin o gyffordd Factory Pool Lane â'r A541 am bellter o 335 i gyfeiriad y de-ddwyrain.

ATODLEN 2 Terfyn Cyflymder 30mya CEI CONNAH

B5129 KELSTERTON ROAD: o'r gyffordd â chylchfan yr A548, am bellter o 410 metr i gyfeiriad y dwyrain.

ATODLEN 3 Terfyn Cyflymder 30mya MAES GLAS

B5121 FFORDD MAES GLAS, MAES GLAS: o bwynt 18 metr i'r gogledd-ddwyrain o gyffordd Level Mine Road â'r B5121 am bellter o 770 metr i gyfeiriad y gogledd-ddwyrain.

ATODLEN 4 Terfyn Cyflymder 30mya EWLO

PARC DEWI SANT: o bwynt 125 metr i'r gogledd ddwyrain o'r gyffordd â Sheridan Avenue am bellter o 592 metr, i'r gyffordd â B5125.

ATODLEN 5
Terfyn Cyflymder 30mya
TREFFYNNON

A5026 HOLWAY ROAD, TREFFYNNON: o bwynt 680 metr i'r gogledd-orllewin o'r gyffordd â Saithaelwyd Park i bwynt 52 metr i'r gogledd-orllewin o'r gyffordd â Carmel Road.

ATODLEN 6
Terfyn Cyflymder 30mya
BRYCHDYN

A5104 Ffordd Yr Wyddgrug A Chyfnewidfa Warren Yr A55: A5104 Ffordd yr Wyddgrug, Brychdyn, am 150 metr i'r de-orllewin o'r gyffordd â'r A55 (mesurir hyn o ganol y gylchfan ddeheuol, i bwynt 75 metr i'r gorllewin o'r gyffordd â The Old Warren.

LESTERS LANE, BRYCHDYN : O bwynt 175 metr o'r gyffordd â'r A5104 am bellter o 72 metr i gyfeiriad y de.

ATODLEN 7
Terfyn Cyflymder 30mya
QUEENSFERRY

B5129 CHESTER ROAD WEST: O'i chyffordd gyda Chylchfan Cyfnewidfa Queensferry, am bellter o 32 metr i gyfeiriad y gogledd.

B5129 CHESTER ROAD EAST: O'i chyffordd gyda Chylchfan Cyfnewidfa Queensferry, am bellter o 197 metr i gyfeiriad y dwyrain. Gan gynnwys cylchfan cyfnewidfa Queensferry.

ATODLEN 8
Terfyn Cyflymder 30mya
BWCLE

B5127 LIVERPOOL ROAD: o bwynt 37 metr i'r gogledd o'r gyffordd â Ffordd Rhuddlan, i bwynt 238 metr i'r gorllewin o'r gyffordd ag Old Liverpool Road.

A549 CHESTER ROAD, BWCLE: o bwynt 32 metr i'r dwyrain o'r gyffordd â Forrest Walk i bwynt 80 metr i'r dwyrain o Little Mountain Road.

B5128 CHURCH ROAD: o'i chyffordd â'r A549, am bellter o 300 metr i gyfeiriad y gogledd.

DRURY LANE: o bwynt 62 metr o'i chyffordd â Lôn Treftadaeth, i bwynt 47 metr i'r gorllewin o gyffordd Ystâd Ddiwydiannol Drury Lane.

ATODLEN 9
Terfyn Cyflymder 30mya
MYNYDD ISA

A549 FFORDD YR WYDDGRUG, MYNYDD ISA: o'r gyffordd â chylchfan Wylfa am bellter o 345 metr i gyfeiriad y gogledd-ddwyrain.

Os ydych yn dymuno gweld copi o'r Hysbysiad hwn, y Gorchymyn a ddaw i rym ar 19 Medi 2023, cynlluniau'n dangos y ffyrdd a effeithir arnynt gan y Gorchymyn a datganiad o resymau'r cyngor dros y Gorchymyn, yn ystod oriau agor arferol y manau canlynol:-

1. Cei Connah yn Cysylltu, Wepre Drive, Cei Connah, Sir y Fflint, CH5 4HA
2. Treffynnon yn Cysylltu, Hen Neuadd y Dref, Stryd Fawr, Treffynnon, CH8 7TD
3. Bwcle yn Cysylltu, Llyfrgell Bwcle, Y Precinct, Bwcle, Sir y Fflint CH7 2EF
4. Yr Wyddgrug yn Cysylltu, Llyfrgell yr Wyddgrug, Earl Road, Yr Wyddgrug, CH7 1AP
5. Canolfan Sir y Fflint yn Cysylltu, Church Street, y Fflint, CH6 5BD

Gellir hefyd eu gweld ar ein gwefan www.siryfflint.gov.uk > Preswyl > Ffyrdd, Strydoedd a Theithio > Gorchmynion Rheoleiddio Traffig neu gellir gofyn am gopi o'r dogfennau drwy anfon e-bost Streetscene@flintshire.gov.uk neu drwy ffonio 01352 701234.

Dyddiedig ddydd Gwener yr 22 diwrnod o Medi 2023



Katie Wilby,
Prif Swyddog (Gwasanaethau Stryd a Thrafnidiaeth),
Neuadd y Sir,
Yr Wyddgrug,
Sir y Fflint.
CH7 6NF

Dyddiedig

19 Medi

2023

**GORCHYMYN CYNGOR SIR Y FFLINT
(GWAHANOL FFYRDD YN SIR Y FFLINT)
(Terfyn Cyflymder 30 mya) 2023**

GORCHYMYN

fel y nodir oddi mewn

**Katie Wilby
Prif Swyddog (Gwasanaethau Stryd a Thrafnidiaeth)
Cyngor Sir y Fflint
Neuadd y Sir
Yr Wyddgrug
Sir y Fflint
CH7 6NF**

**GORCHYMYN CYNGOR SIR Y FFLINT
(GWAHANOL FFYRDD YN SIR Y FFLINT)
(Terfyn Cyflymder 30 mya) 2023**

Mae Cyngor Sir y Fflint (y cyfeirir ato o hyn ymlaen fel "y Cyngor") wrth ddefnyddio'i bwerau dan Adran 82 (2) (a), 84 o'r Ddeddf Rheoleiddio Traffig Ffyrdd 1984 (y cyfeirir ato o hyn ymlaen fel "Deddf 1984") a phob pŵer galluogi arall ac ar ôl ymgynghori â Phrif Swyddog yr Heddlu yn unol â Rhan III Atodlen 9 Deddf 1984, yn gwneud y Gorchymyn canlynol:

1. Ac eithrio lle nodir yn wahanol, mae unrhyw gyfeiriad yn y Gorchymyn hwn at Erthygl neu Atodlen â rhif, yn gyfeiriad at yr Erthygl neu'r Atodlen sy'n dwyn y rhif hwnnw yn y Gorchymyn hwn.
2. Ni chaiff unrhyw berson yrru unrhyw gerbyd modur ar gyflymder uwch na 30 milltir yr awr ar y darnau o ffyrdd a nodir yn yr Atodlenni i'r Gorchymyn.
3. Ni fydd y ffordds a nodir yn yr Atodlenni 1, 2, 3, 4, 5, 6, 7, 8 a 9 i'r Rhybudd hwn bellach yn Ffordd Gyfyngedig at ddibenion Adran 81 o'r Ddeddf hon.
4. Bydd Deddf Dehongli 1978 yn berthnasol ar gyfer dehongliad y Gorchymyn hwn gan ei fod yn berthnasol ar gyfer dehongli Deddf Seneddol.
5. Bydd y Gorchymyn hwn yn dod i rym ar 19 Medi 2023 ac fe'i adnabyddir fel Gorchymyn Cyngor Sir y Fflint (GWAHANOL FFYRDD YN SIR Y FFLINT) (Terfyn Cyflymder 30mya) 2023.

**ATODLEN 1
Terfyn Cyflymder 30mya
YR WYDDGRUG**

A541 FFORDD DINBYCH: o bwynt 17 metr i'r gogledd-orllewin o gyffordd Factory Pool Lane â'r A541 am bellter o 335 i gyfeiriad y de-ddwyrain.

**ATODLEN 2
Terfyn Cyflymder 30mya
CEI CONNAH**

B5129 KELSTERTON ROAD: o'r gyffordd â chylchfan yr A548, am bellter o 410 metr i gyfeiriad y dwyrain.

ATODLEN 3
Terfyn Cyflymder 30mya
MAES GLAS

B5121 FFORDD MAES GLAS: o bwynt 18 metr i'r gogledd-ddwyrain o gyffordd Level Mine Road â'r B5121 am bellter o 770 metr i gyfeiriad y gogledd-ddwyrain.

ATODLEN 4
Terfyn Cyflymder 30mya
EWLO

PARC DEWI SANT: o bwynt 125 metr i'r gogledd ddwyrain o'r gyffordd â Sheridan Avenue am bellter o 592 metr, i'r gyffordd â B5125.

ATODLEN 5
Terfyn Cyflymder 30mya
TREFFYNNON

A5026 HOLWAY ROAD: o bwynt 680 metr i'r gogledd-orllewin o'r gyffordd â Saithaelwyd Park i bwynt 52 metr i'r gogledd-orllewin o'r gyffordd â Carmel Road.

ATODLEN 6
Terfyn Cyflymder 30mya
BRYCHDYN

A5104 FFORDD YR WYDDGRUG A CHYFNEWIDFA WARREN YR A55: A5104 Ffordd yr Wyddgrug, Brychdyn, am 150 metr i'r de-orllewin o'r gyffordd â'r A55 (mesurir hyn o ganol y gylchfan ddeheuol, i bwynt 75 metr i'r gorllewin o'r gyffordd â The Old Warren.

LESTERS LANE: O bwynt 175 metr o'r gyffordd â'r A5104 am bellter o 72 metr i gyfeiriad y de.

ATODLEN 7
Terfyn Cyflymder 30mya
QUEENSFERRY

B5129 CHESTER ROAD WEST: O'i chyffordd gyda Chylchfan Cyfnewidfa Queensferry, am bellter o 32 metr i gyfeiriad y gogledd.

B5129 CHESTER ROAD EAST: O'i chyffordd gyda Chylchfan Cyfnewidfa Queensferry, am bellter o 197 metr i gyfeiriad y dwyrain. Gan gynnwys cylchfan cyfnewidfa Queensferry.

ATODLEN 8
Terfyn Cyflymder 30mya
BWCLE

B5127 LIVERPOOL ROAD: o bwynt 37 metr i'r gogledd o'r gyffordd â Ffordd Rhuddlan, i bwynt 238 metr i'r gorllewin o'r gyffordd ag Old Liverpool Road.

A549 CHESTER ROAD: o bwynt 32 metr i'r dwyrain o'r gyffordd â Forrest Walk i bwynt 80 metr i'r dwyrain o Little Mountain Road.

B5128 CHURCH ROAD: o'i chyffordd â'r A549, am bellter o 300 metr i gyfeiriad y gogledd.

DRURY LANE: o bwynt 62 metr o'i chyffordd â Lôn Treftadaeth, i bwynt 47 metr i'r gorllewin o gyffordd Ystâd Ddiwydiannol Drury Lane.

ATODLEN 9
Terfyn Cyflymder 30mya
MYNYDD ISA

A549 FFORDD YR WYDDGRUG: o'r gyffordd â chylchfan Wylfa am bellter o 345 metr i gyfeiriad y gogledd-ddwyrain.

GOSODWYD SÊL GYFFREDIN CYNGOR)
SIR Y FFLINT ar y 19)
diwrnod o Medi 2023 ym mhresenoldeb :-)

Y CADEIRYDD



RHEOLWR Y GWASANAETHAU CYFREITHIOL

PRIF SWYDDOG (LLYWODRAETHU)



UWCH GYFREITHIWR



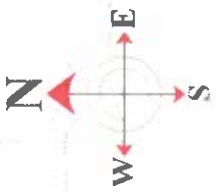

CPJ MP

KEY

Terfyn Cyflymder
30 mya
30mph Speed limit



This plan is submitted to the Council for their consideration and does not constitute an offer of any financial product. It is subject to the terms and conditions of the relevant financial product. The Council is not responsible for the accuracy of the information provided in this plan. The Council is not responsible for any loss or damage arising from the use of this plan. The Council is not responsible for any loss or damage arising from the use of this plan.

TECHNICAL APPROVAL CONSTRUCTION



Terfyn Cyflymder 30 mya
30mph Speed limit
A5104 Ffordd Yr Wydrigws A Chytrigws
Warren Yr A55, Lesters Lane, Rhydymwyn
A5104 Mold Road and A55 Warren
Interchange Lester Lane Broughton

HT 2/Broughton/01

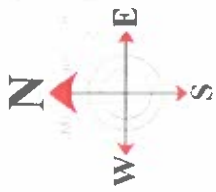

Handwritten signature and initials: CJP MP

KEY

- Terfyn Cyflymder
- 30mya
- 30mph Speed limit

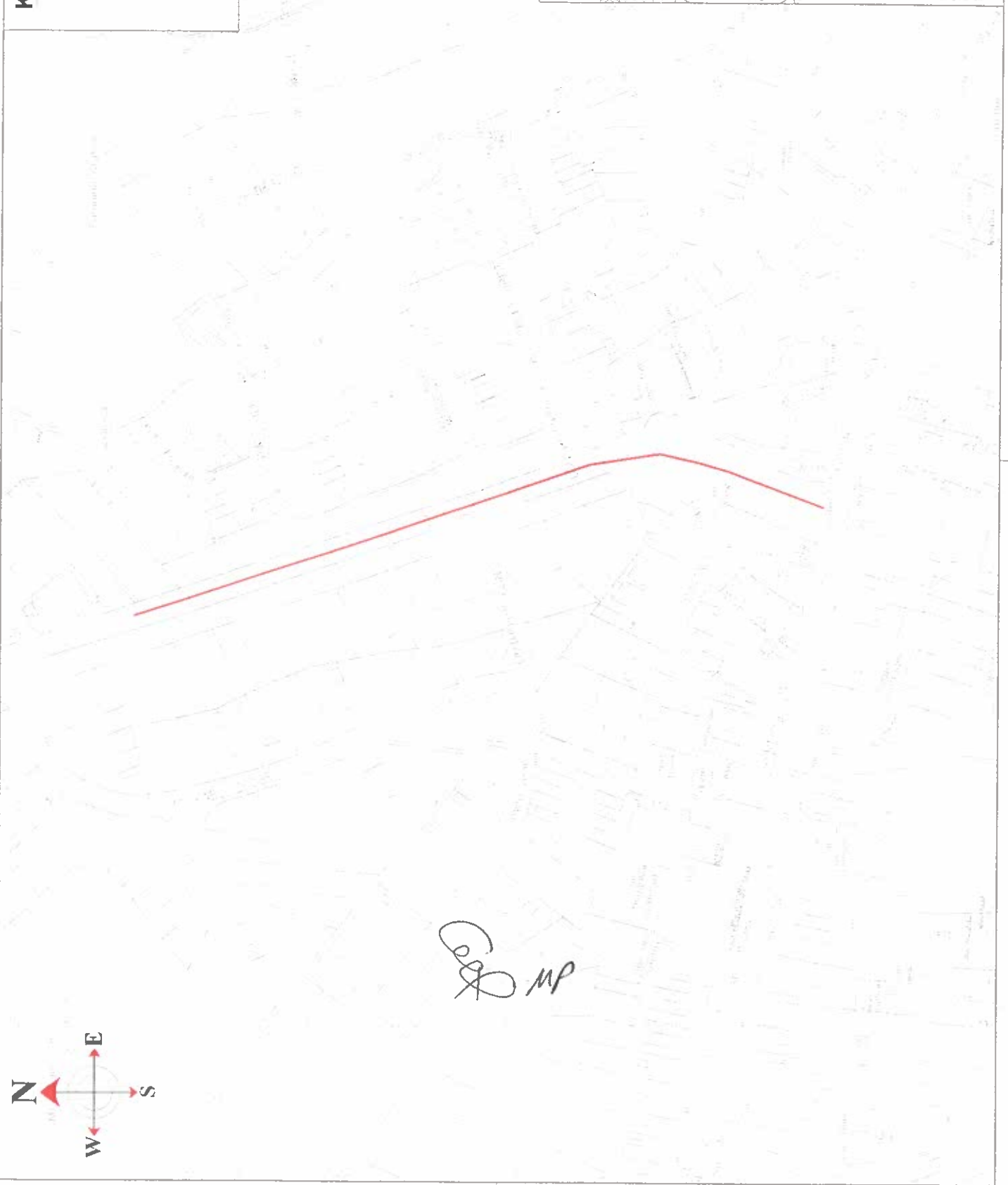

This document is the property of Sir y Fflint Flintshire Council. It is to be used only for the purposes for which it is issued. It is not to be distributed, copied, or otherwise used for any other purpose without the prior written consent of Sir y Fflint Flintshire Council.

PRELIMINARY APPROVAL CONSTRUCTION



Terfyn Cyflymder 30mya
30mph Speed Limit

B5128 Church Road, Bowle

B5128 Church Road, Buckley

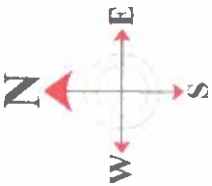

Colt MP

KEY

Terfyn Cyflymder
30 mya
30mph Speed limit



This document is the property of Flintshire County Council. It is to be used only for the purposes for which it is issued. It is not to be reproduced, stored in a retrieval system, or transmitted in any form or by any means, electronic, mechanical, photocopying, recording, or by any information storage and retrieval system, without the prior written permission of Flintshire County Council.

PRELIMINARY APPROVAL CONSTRUCTION



Terfyn Cyflymder, 30mya
30mph Speed Limit

85129 KELSTERTON ROAD

Cei Cornah/Commins Quay

10/11

11/20/2014

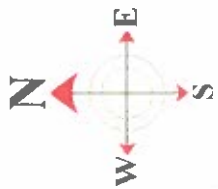

KEY

Terfyn Cyflymder
30mya
30mph Speed limit



Carl MP

This plan is submitted in accordance with the provisions of the Traffic Signs Regulations and General Directions 2002. It is intended to be used in conjunction with the Traffic Signs Manual. The Council is not responsible for any errors or omissions. The Council is not liable for any damage or loss arising from the use of this plan.

PREPARED BY: [] APPROVAL: [] CONSTRUCTION: []



Terfyn Cyflymder 30mya
30mph Speed Limit
A549 Chester Road
Bwlch/Buckley
HTC/30mya Mile/20 1/11

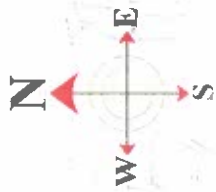

Handwritten signature/initials

KEY

Terfyn Cyflymder
30mya
30mph Speed limit

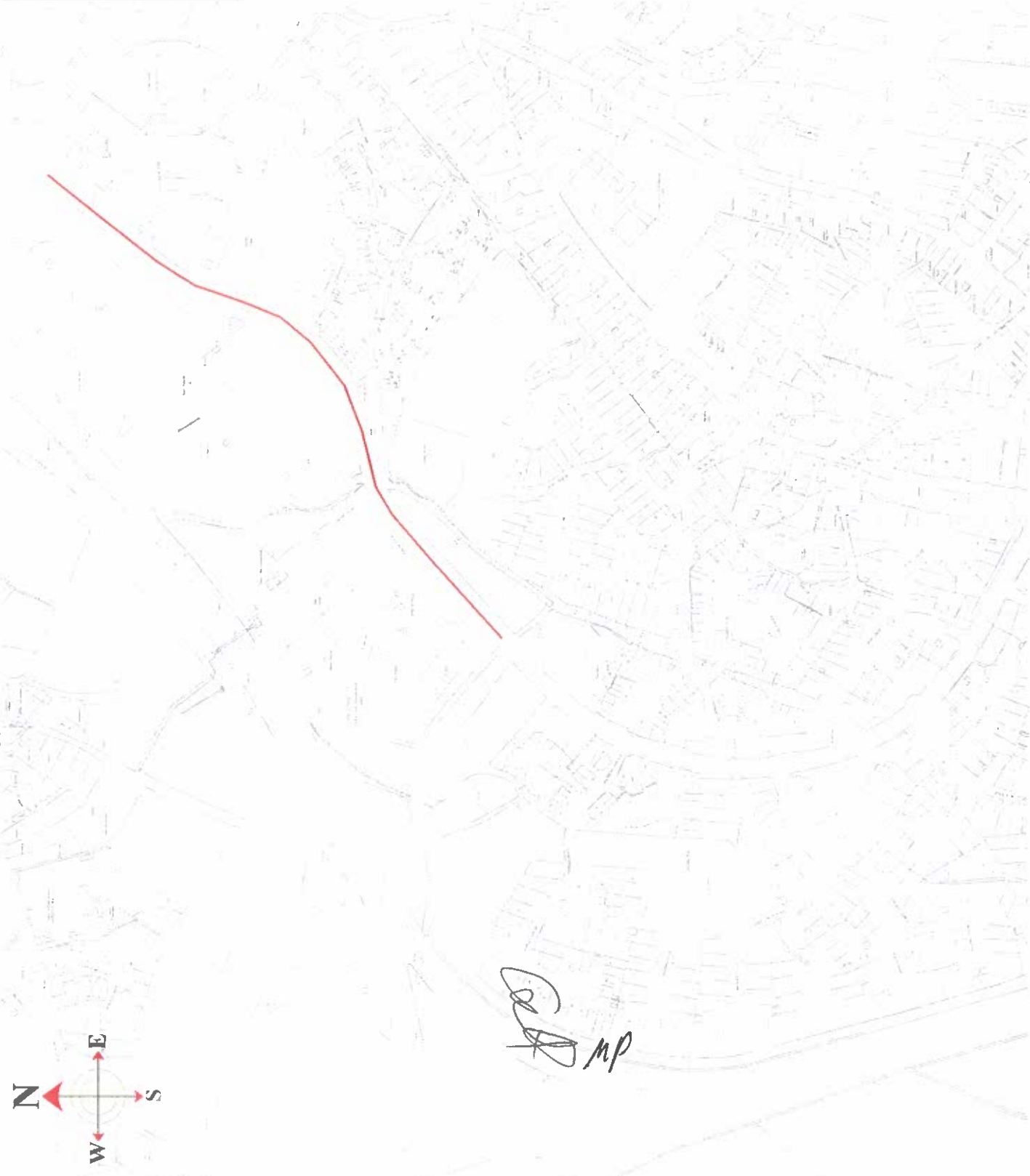

This document is the property of Flintshire County Council. It is to be used only for the purpose for which it is issued. It is not to be reproduced, stored in a retrieval system, or transmitted in any form or by any means, electronic, mechanical, photocopying, recording, or by any information storage and retrieval system, without the prior written permission of Flintshire County Council.

RECOMMENDED APPROVAL CONSTRUCTION



Terfyn Cyflymder 30mya
30mph Speed Limit
PARC DEWI SANT EWLO
ST DAVIDS PARK EWLOE

HT/23/EW/06/201

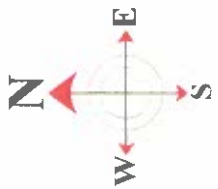

Carl MP

KEY

Terfyn Cyflymder
30 mya
30mph Speed limit

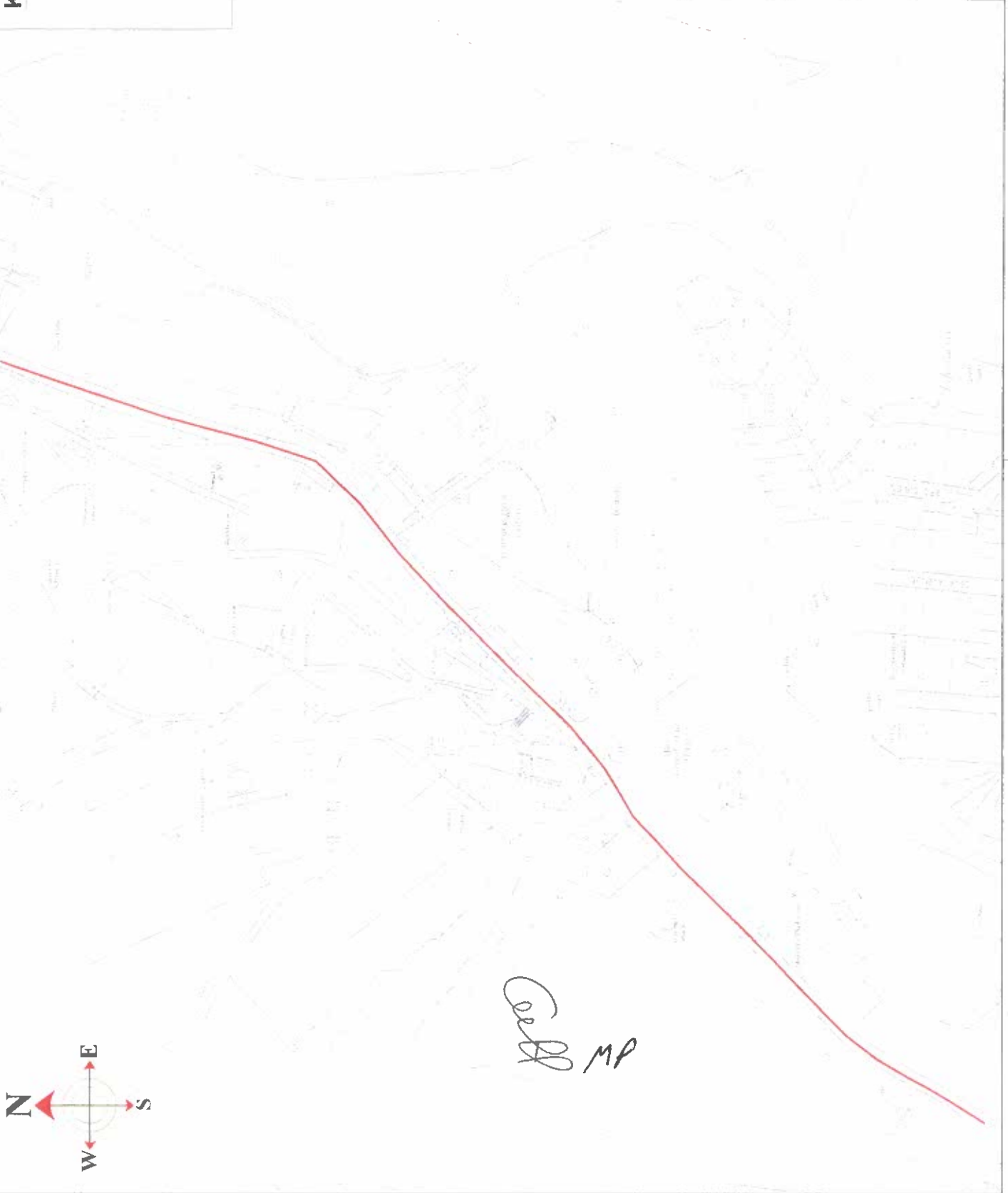

This plan is preliminary and is subject to change without notice. It is not to be used for any other purpose than that for which it is intended. It is not to be construed as a guarantee of any kind.

PRELIMINARY APPROVAL CONSTRUCTION



Terfyn Cyflymder 30 mya
30mph Speed Limit

B5121 Ffordd Maes Glas Maes Glas
B5121 Greenfield Road Greenfield

HT/23/Creenfield/201 P1

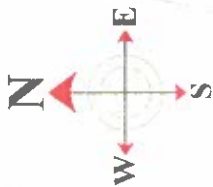

KEY

Terfyn Cyflymder
30 mya
30mph Speed limit



Carl Hall MP

This drawing has been prepared for the purpose of providing information only. It is not to be used for any other purpose without the written consent of the author.

PRELIMINARY APPROVAL CONSTRUCTION



Terfyn Cyflymder 30 mya
30mph Speed Limit

A5035 HOLWAY ROAD,
TREFFYNNON/HOLYWELL

HT/23/Holywell/2011

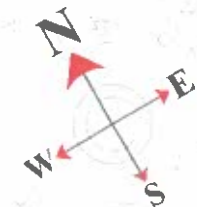

Coed MP

KEY

Terfyn Cyflymder
30mya
30mph Speed limit

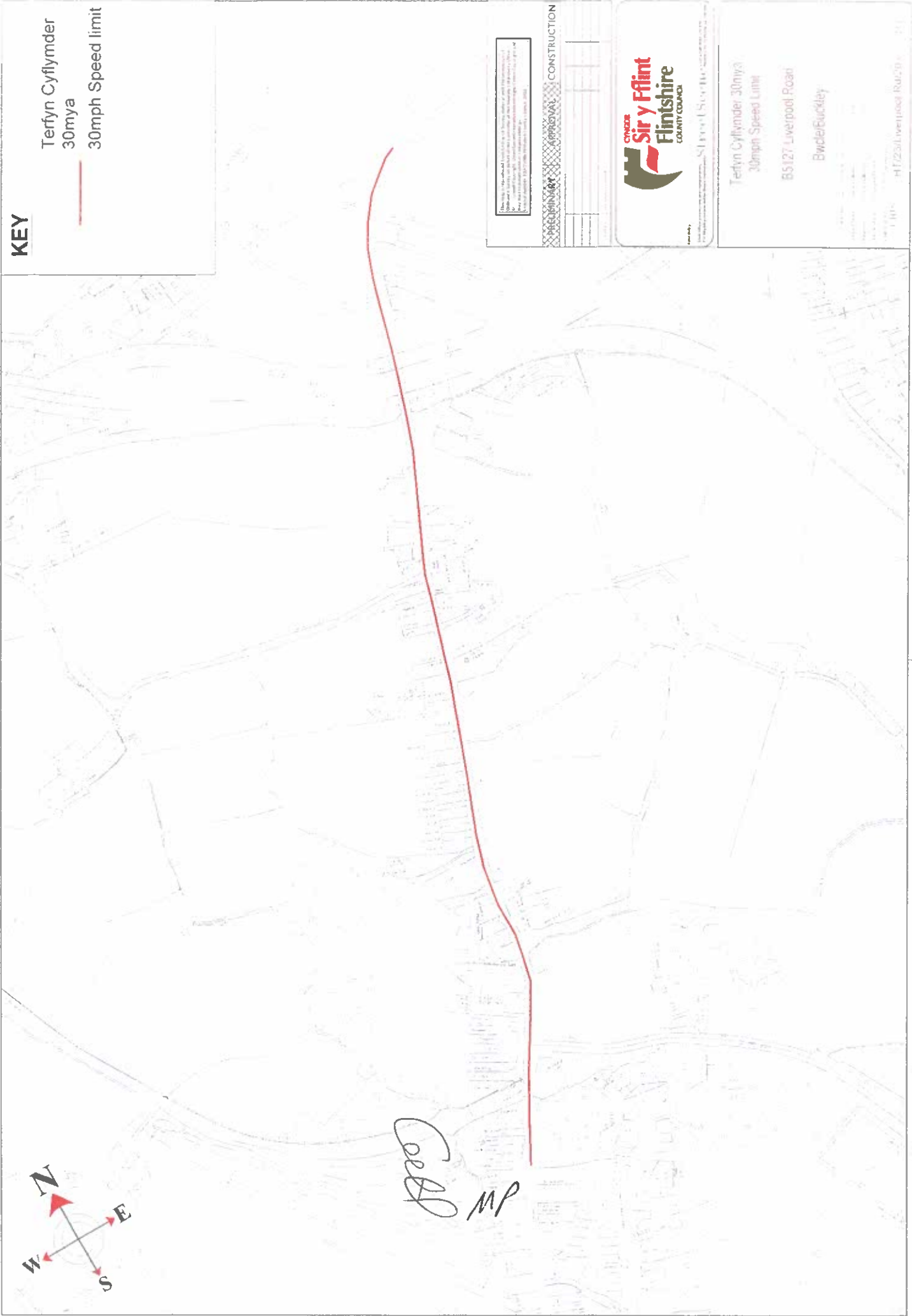

This plan has been prepared for the purpose of illustrating the proposed works and does not constitute an offer of any financial product. It is intended for use by the Council and its officers only. It is not to be used for any other purpose. The Council is not responsible for any loss or damage arising from the use of this plan.

CONSTRUCTION



Terfyn Cyflymder 30mya
30mph Speed Limit
BS127 Liverpool Road
Bwlder/Buckley

HF/23/Liverpool Road



Carla

KEY

Terfyn Cyflymder
30' mya
30mph Speed limit

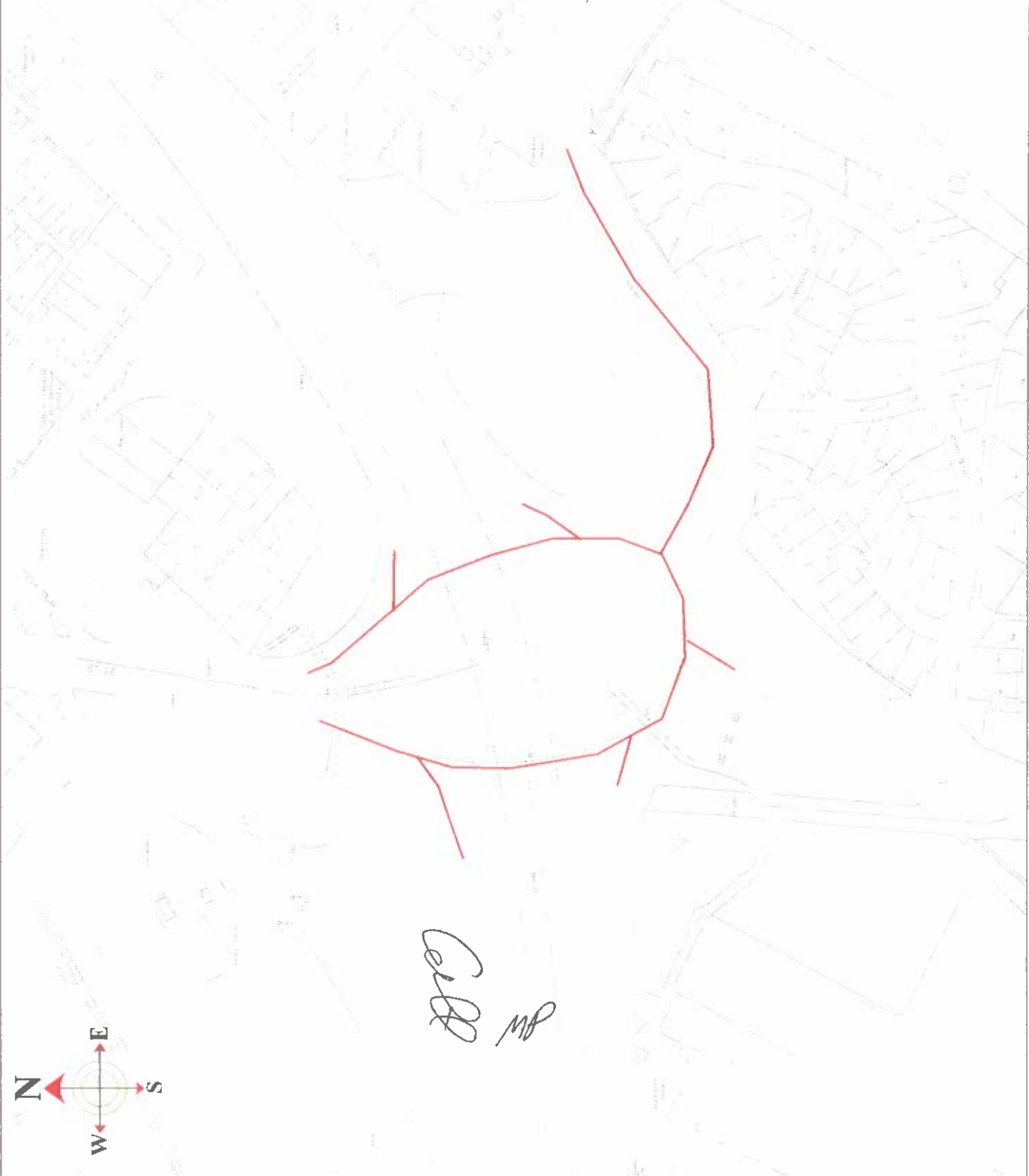

This plan is the property of Flintshire County Council. It is not to be used for any other purpose without the written permission of the Council. It is not to be reproduced, stored in a retrieval system, or transmitted in any form or by any means, electronic, mechanical, photocopying, recording, or by any information storage and retrieval system, without the prior written permission of the Council.

PREPARED BY: *[Signature]* APPROVED BY: *[Signature]* CONSTRUCTION



Flintshire County Council
100, Chester Road West, Flint, Flintshire, CH6 1JH
Tel: 01248 862000 Fax: 01248 862001
www.flintshire.gov.uk

Terfyn Cyflymder 30' mya
30mph Speed Limit
B5129 CHESTER ROAD WEST
B5129 CHESTER ROAD EAST

HT2390-Flint709

**GORCHYMYN CYNGOR SIR Y FFLINT
AMRYWIOL FFYRDD YN SIR Y FFLINT
(TERFYN CYFLYMDER 30 MYA) 202-**

DATGANIAD O'R RHESYMAU DROS GYNNIG GWNEUD Y GORCHYMYN

Bydd Llywodraeth Cymru yn cyflwyno terfyn cyflymder 20mya diofyn cenedlaethol ar bob ffordd gyfyngedig yng Nghymru o 17 Medi 2023.

Mae ffyrdd cyfyngedig fel arfer wedi'u lleoli mewn ardaloedd preswyl ac adeiledig ac mae ganddynt system o oleuadau stryd.

Mae Llywodraeth Cymru wedi cynghori y gallai lleihau'r cyfyngiad cyflymder o 30mya i 20mya ar ffyrdd cyfyngedig arwain at lawer o fanteision. Mae manteision lleihau'r terfyn cyflymder yn cynnwys:

- Gwella diogelwch wrth ymyl ysgolion a lleoliadau eraill sydd â llawer o gerddwyr
- Gwella diogelwch cerddwyr a beicwyr
- Annog pobl i beidio â defnyddio strydoedd preswyl ar adegau prysur
- Gwella hygyrchedd drwy leihau goruchafiaeth cerbydau modur ar y briffordd

Mae meini prawf 'lleoliad' wedi'u datblygu i benderfynu ymhle dylid gosod terfynau cyflymder o 20mya, gan ddarparu dull cyson ar draws Cymru.

Ni fydd pob ffordd gyfyngedig sydd â therfyn 30mya ar hyn o bryd yn addas i'w newid i 20mya. Ym mis Tachwedd 2022 cyflwynodd Llywodraeth Cymru 'feini prawf eithriadau'. Diben hwn oedd rhoi rhywfaint o hyblygrwydd i gynghorau lleol i gadw terfynau cyflymder 30mya, lle bo hynny'n briodol, ar rai ffyrdd cyfyngedig. Gelwir y rhain yn 'eithriadau' i'r terfyn cyflymder rhagosodedig ar gyfer ffyrdd cyfyngedig ac mae Gorchmynion Cyfreithiol yn barod i gadw'r terfyn cyflymder presennol ar gyfer y ffyrdd hyn. Asesir pob terfyn cyflymder yn ddiuedd ac yn unol â meini prawf cenedlaethol penodol.

I bennu 'eithriad' i ffordd gyfyngedig, mae'n rhaid i gynghorau lleol gael achos clir a rhesymegol dros wneud hynny sy'n profi bod tystiolaeth gref yn bodoli y byddai cadw terfyn cyflymder uwch yn ddiogel.

Yn dilyn asesiad o ffyrdd lleol, a gweithio'n agos gyda Chynghorwyr Sir, mae nifer o ffyrdd yn Sir y Fflint wedi'u nodi fel eithriadau posibl sydd ar gael i'r cyhoedd eu harchwilio ar DataMap Wales.

Mae'r rhannau o'r ffyrdd isod ar hyn o bryd yn 30mya yn ôl statws ffordd gyfyngedig. Mae'r Awdurdod yn ystyried bod y terfyn cyflymder 30mya presennol yn derfyn cyflymder priodol yn y lleoliadau hyn ac felly nid yw'n bodloni'r meini prawf na natur ffordd ar gyfer terfyn cyflymder 20mya.

- Parc Dewi Sant, Ewlo
- A541 Hendre
- A541 Ffordd Dinbych – Yr Wyddgrug
- A5104 Cyfnewidfa Warren Bank - Brychdyn
- A5026 Holway Road - Treffynnon
- B5121 Ffordd Maes Glas - Treffynnon
- B5129 Kelsterton Road - Kelsterton

- B5129 Cylchfan Queensferry
- A549 Ffordd yr Wyddgrug – Mynydd Isa
- A549 Chester Rd / Dirty Mile - Little Mountain

Mae'r rhannau o'r ffordd isod eisoes yn destun terfyn cyflymder 20mya a roddwyd ar waith yn 2022, fel rhan o gam cyntaf gweithredu newid y terfyn cyflymder rhagosodedig i 20mya ym Mwcle a'r ardaloedd cyfagos. Nid yw'r Awdurdod yn ystyried bod y terfyn cyflymder 20mya presennol yn derfyn cyflymder priodol yn y lleoliadau hyn ac felly nid yw'n bodloni'r meini prawf na natur ffordd ar gyfer terfyn cyflymder 20mya.

- B5127 Liverpool Road
- B5128 Church Rd
- Drury Lane
- White Farm Road

Manylir ar y cynigion yn yr Hysbysiad Cyhoeddus ac yn y Gorchymyn Drafft arfaethedig.

Dyddiedig ddydd Gwener yr 28ain diwrnod o Orffennaf 2023



Katie Wilby,
Prif Swyddog (Gwasanaethau Stryd a Thrafnidiaeth),
Neuadd y Sir,
Yr Wyddgrug,
Sir y Fflint.
CH7 6NF

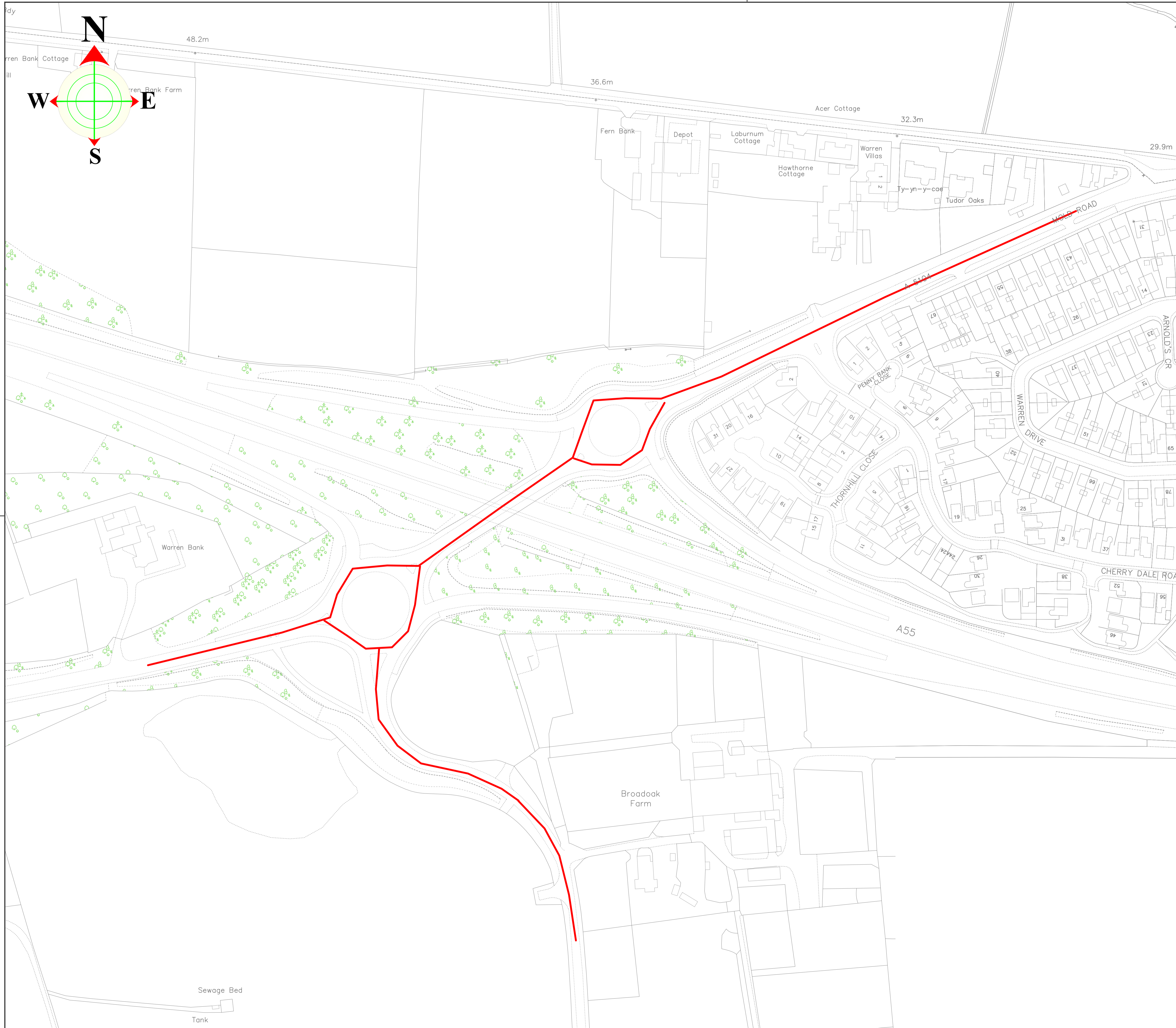

KEY

Terfyn Cyflymder
30`mya

30mph Speed limit

This map is reproduced from Ordnance Survey material with the permission of Ordnance Survey on behalf of the Controller of Her Majesty's Stationery Office. © Crown Copyright. Unauthorised reproduction infringes Crown Copyright and may lead to prosecution or civil proceedings. Licence number 100023386. Flintshire County Council, 2018.

PRELIMINARY	APPROVAL	CONSTRUCTION
-------------	----------	--------------

PH/Rev.	Revision Details	Rev.by	Chk.by	Date



Katie Wilby
Chief Officer (Streetscene and Transportation)
Prif Swyddog (Gwasanaethau Stryd a Thrafnidiaeth)

StreetScene County Hall, Mold, CH7 6NF
Heoldd y Sir, Yr Wyddgrug, CH7 6NF

Project:

Terfyn Cyflymder 30`mya
30mph Speed limit
A5104 Ffordd Yr Wyddgrug A Chyfnwidfa,
Warren Yr A55, Lesters Lane, Brychdyn

A5104 Mold Road and A55 Warren
Interchange, Lester Lane, Broughton

Flintshire County Council - Environment Directorate, County Hall 1, Mold CH7 6NF			
Contact Name:	Nick Williams	Telephone:	01352 704642
Drawn by:	Nick Williams	Fax No:	01352 70
Checked by:	Richard Flood	Date:	SEP 2023
Scales at A1:	1:NTS	Drawing No:	HT/23/Broughton/201
Phase/Rev:	P1	Sheet	1 of 1

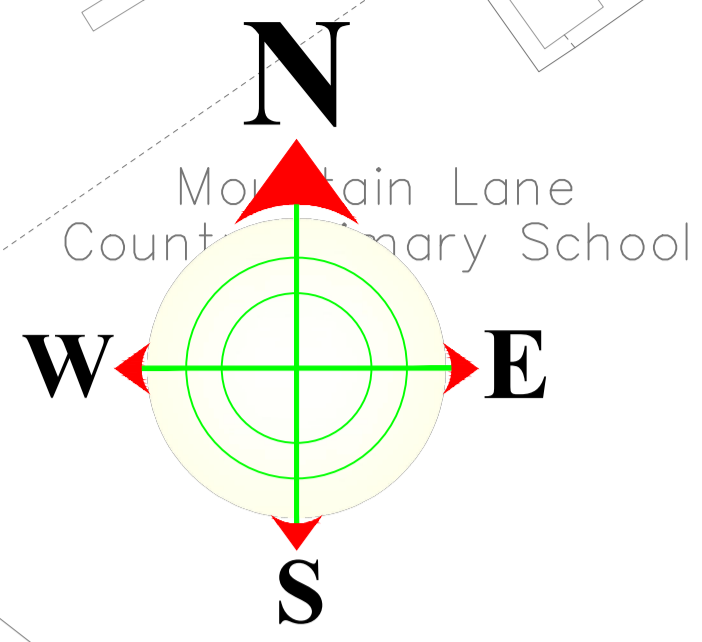

KEY

Terfyn Cyflymder
30mya
30mph Speed limit

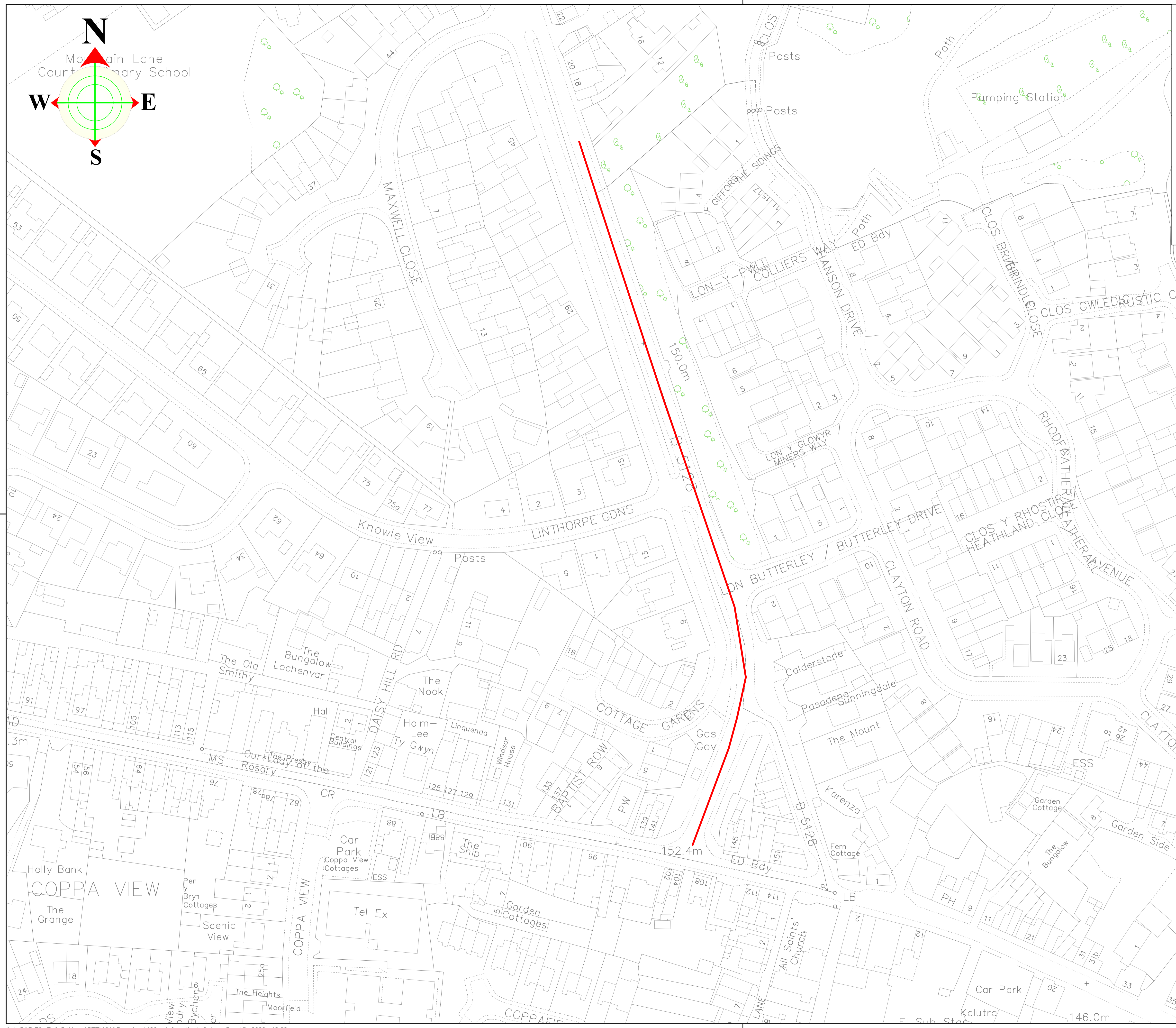

This map is reproduced from Ordnance Survey material with the permission of Ordnance Survey on behalf of the Controller of Her Majesty's Stationery Office. © Crown Copyright. Unauthorised reproduction infringes Crown Copyright and may lead to prosecution or civil proceedings. Licence number 100023386.Flintshire County Council, 2018.

PRELIMINARY	APPROVAL	CONSTRUCTION
-------------	----------	--------------

PH/Rev.	Revision Details	Rev.by	Chk.by	Date



StreetScene

Terfyn Cyflymder 30mya
30mph Speed Limit

B5128 Church Road, Bwcle
B5128 Church Road, Buckley

Flintshire County Council - Environment Directorate, County Hall 1, Mold CH7 6NF			
Contact Name:	Nick Williams	Telephone:	01352 704642
Drawn by:	Nick Williams	Fax No:	01352 70
Checked by:	Richard Flood	Date:	SEP 2023
Scales at A1:	Drawing No:	Phase/Rev:	
1: NTS	HT/23/Church Rd/201	P1	

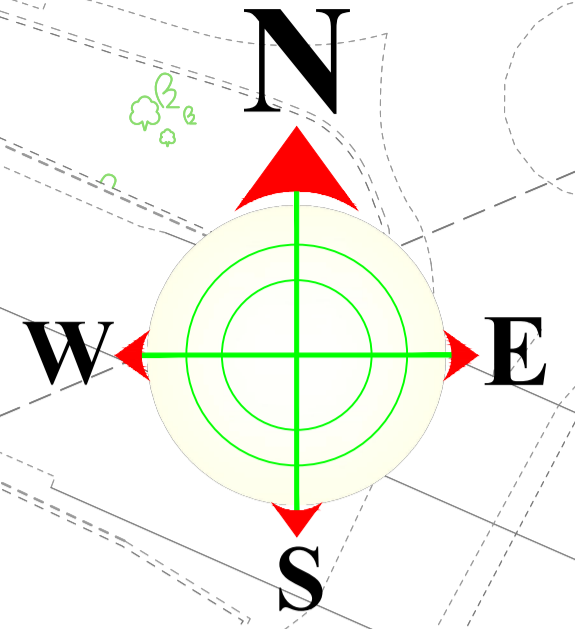

KEY

Terfyn Cyflymder
30`mya

30mph Speed limit



This map is reproduced from Ordnance Survey material with the permission of Ordnance Survey on behalf of the Controller of Her Majesty's Stationery Office. © Crown Copyright. Unauthorised reproduction infringes Crown Copyright and may lead to prosecution or civil proceedings. Licence number 100023386.Flintshire County Council, 2018.

PRELIMINARY	APPROVAL	CONSTRUCTION
-------------	----------	--------------

PH/Rev.	Revision Details	Rev.by	Chk.by	Date



Katie Wilby
Chief Officer (Streetscene and Transportation)
Prif Swyddog (Gwasanaethau Strydau Trafnidwrth)

StreetScene
County Hall, Mold, CH7 6NF
Hauddis y Sir, Yr Wyddgrug, CH7 6NF

Project:

Terfyn Cyflymder 30mya
30mph Speed Limit

B5129 KELSTERTON ROAD

Cei Connah/Connahs Quay

Flintshire County Council - Environment Directorate, County Hall 1, Mold CH7 6NF			
Contact Name:	Nick Williams	Telephone:	01352 704642
Drawn by:	Nick Williams	Fax No:	01352 70
Checked by:	Richard Flood	Date:	SEP 2023
Scales at A1:	Drawing No:	Phase/Rev:	
1:NTS	HT/23/C-Quay/201	P1	

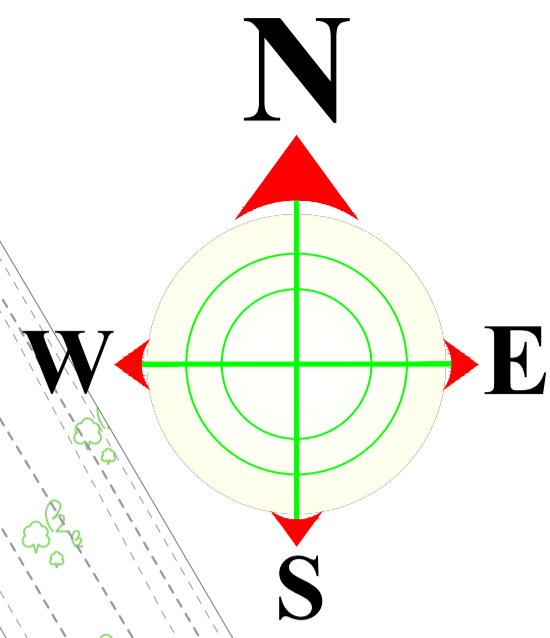

KEY

Terfyn Cyflymder
30mya
30mph Speed limit

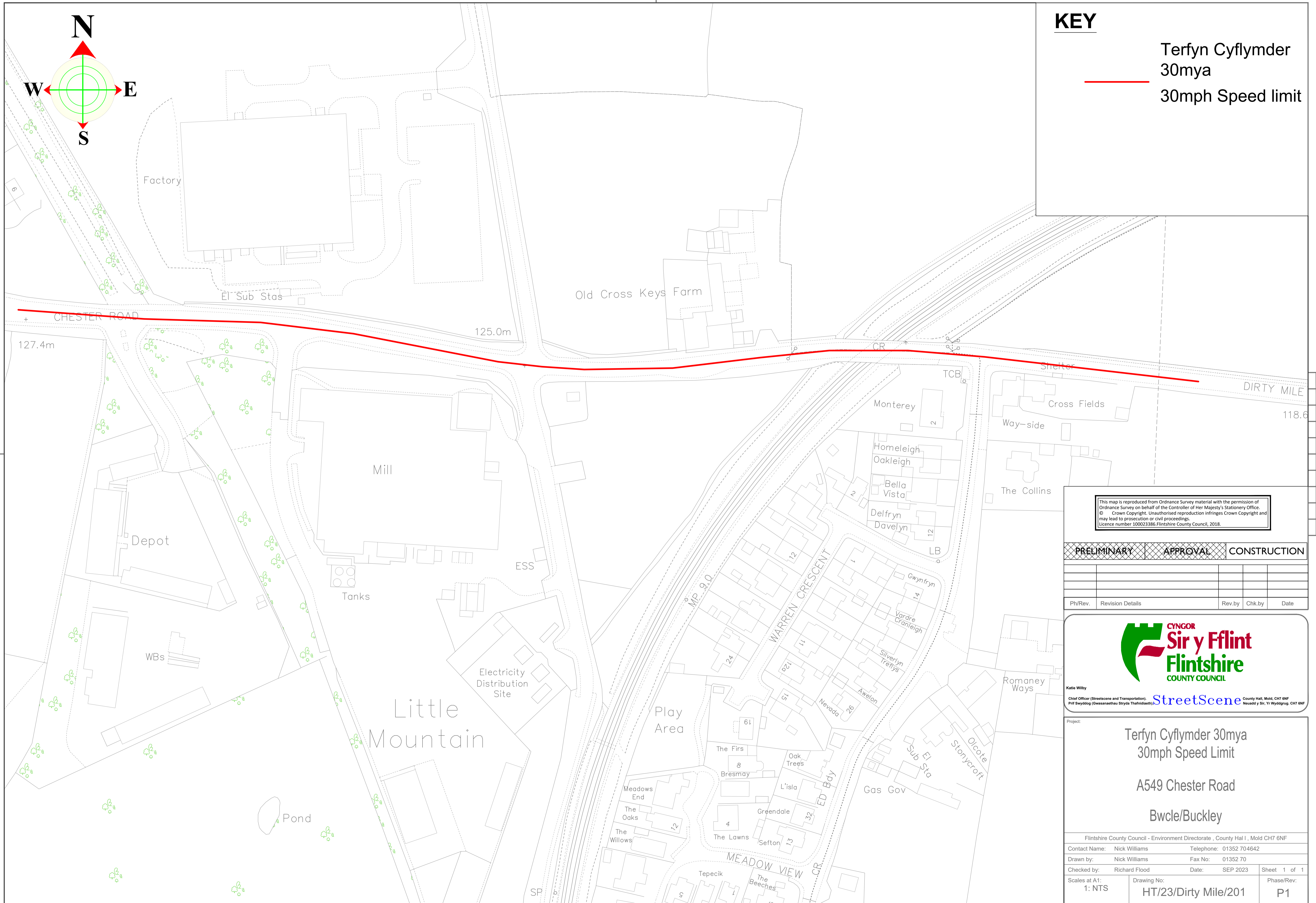

This map is reproduced from Ordnance Survey material with the permission of Ordnance Survey on behalf of the Controller of Her Majesty's Stationery Office. © Crown Copyright. Unauthorised reproduction infringes Crown Copyright and may lead to prosecution or civil proceedings. Licence number 100023386.Flintshire County Council, 2018.

PRELIMINARY	APPROVAL	CONSTRUCTION
PH/Rev.	Revision Details	Rev.by Chk.by Date



StreetScene County Hall, Mold, CH7 6NF
Haudd y Sir, Yr Wyddgrug, CH7 6NF

Project:

**Terfyn Cyflymder 30mya
30mph Speed Limit**

A549 Chester Road

Bwcle/Buckley

Flintshire County Council - Environment Directorate, County Hall 1, Mold CH7 6NF

Contact Name: Nick Williams Telephone: 01352 704642

Drawn by: Nick Williams Fax No: 01352 70

Checked by: Richard Flood Date: SEP 2023 Sheet 1 of 1

Scales at A1: 1: NTS Drawing No: HT/23/Dirty Mile/201 Phase/Rev: P1

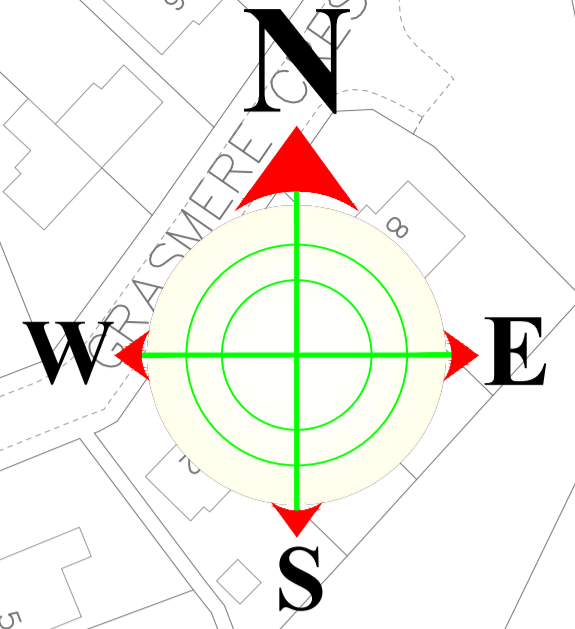
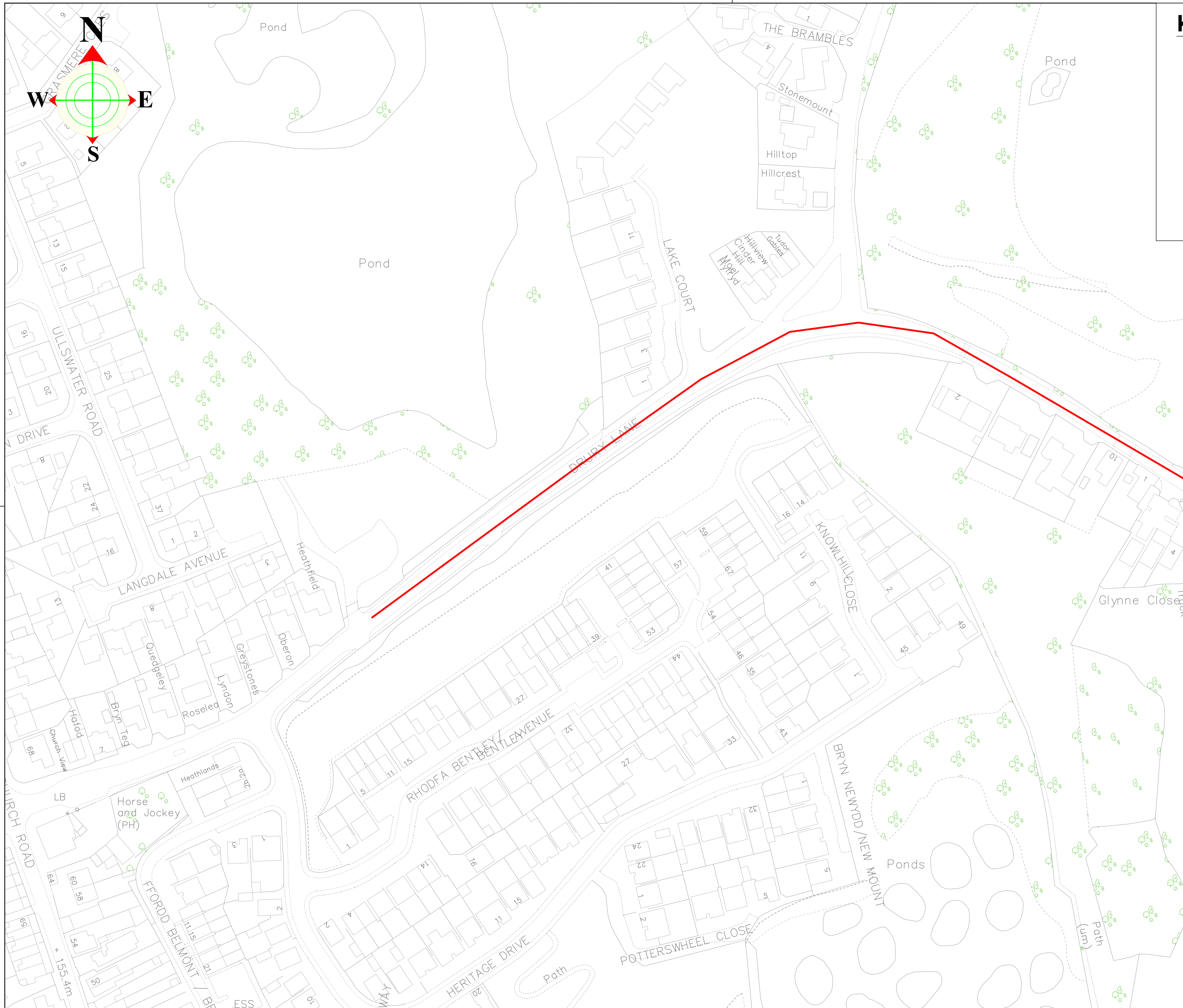

KEY

Terfyn Cyflymder
30mya
30mph Speed limit

This map is reproduced from Ordnance Survey material with the permission of Ordnance Survey on behalf of the Controller of Her Majesty's Stationery Office. © Crown Copyright. Unauthorised reproduction infringes Crown Copyright and may lead to prosecution or civil proceedings. Licence number 100023386. Flintshire County Council, 2018.

PRELIMINARY	APPROVAL	CONSTRUCTION
-------------	----------	--------------

PH/Rev.	Revision Details	Rev.by	Chk.by	Date



Katie Wilby
Chief Officer (Streetscene and Transportation)
Prif Swyddog (Gwasanaethau Stryd a Thrafnidiaeth)

StreetScene
County Hall, Mold, CH7 6NF
Haudd y Sir, Yr Wyddgrug, CH7 6NF

Terfyn Cyflymder 30mya
30mph Speed Limit
Drury Lane, Drury

Flintshire County Council - Environment Directorate, County Hall 1, Mold CH7 6NF			
Contact Name:	Nick Williams	Telephone:	01352 704642
Drawn by:	Nick Williams	Fax No:	01352 70
Checked by:	Richard Flood	Date:	SEP 2023
Scales at A1:	1: NTS	Drawing No:	HT/23/Duruy Lane/201
Phase/Rev:	P1	Sheet	1 of 1

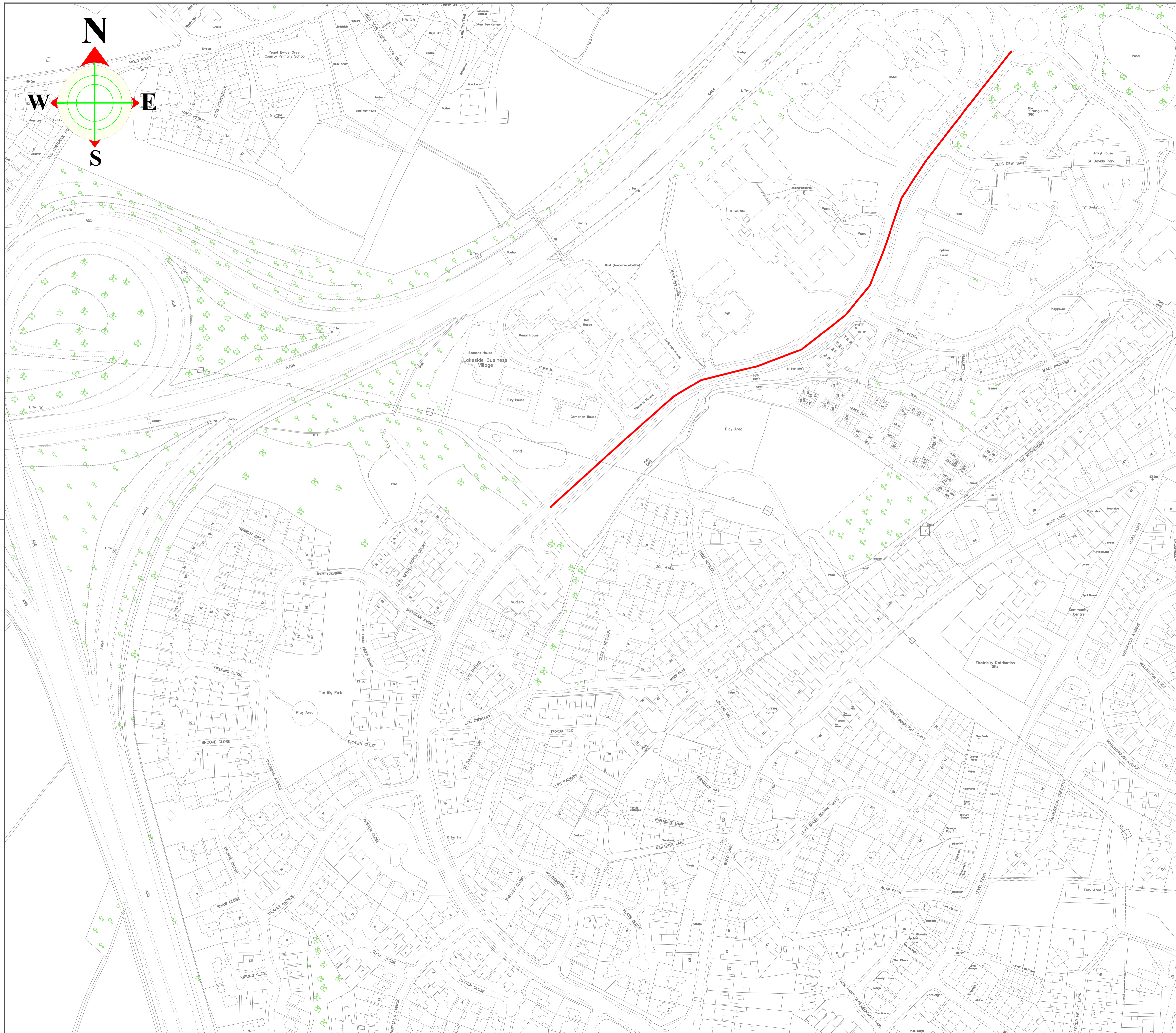

KEY

Terfyn Cyflymder
30mya
30mph Speed limit

This map is reproduced from Ordnance Survey material with the permission of Ordnance Survey on behalf of the Controller of Her Majesty's Stationery Office. © Crown Copyright. Unauthorised reproduction infringes Crown Copyright and may lead to prosecution or civil proceedings. Licence number 100023386. Flintshire County Council, 2018.

PRELIMINARY	APPROVAL	CONSTRUCTION
-------------	----------	--------------

PH/Rev.	Revision Details	Rev.by	Chk.by	Date



Katie Wilby
Chief Officer (Streetscene and Transportation)
Prif Swyddog (Gwasanaethau Stryd a Thrafnidiaeth)

StreetScene
County Hall, Mold, CH7 6NF
Heuadd y Sir, Yr Wyddgrug, CH7 6NF

Terfyn Cyflymder 30mya
30mph Speed Limit
PARC DEWI SANT EWLO
ST DAVIDS PARK EWLOE

Flintshire County Council - Environment Directorate, County Hall 1, Mold CH7 6NF			
Contact Name:	Nick Williams	Telephone:	01352 704642
Drawn by:	Nick Williams	Fax No:	01352 70
Checked by:	Richard Flood	Date:	SEP 2023
Scales at A1:	1: NTS	Drawing No:	HT/23/Ewloe/201
Phase/Rev:	P1	Sheet	1 of 1

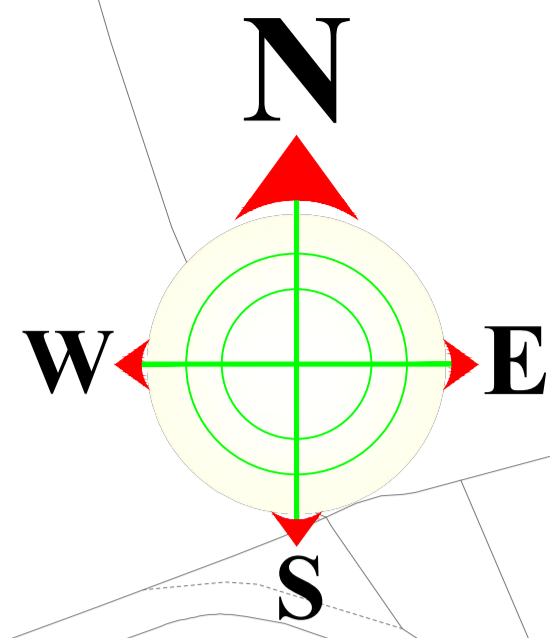

KEY

Terfyn Cyflymder
30`mya
30mph Speed limit

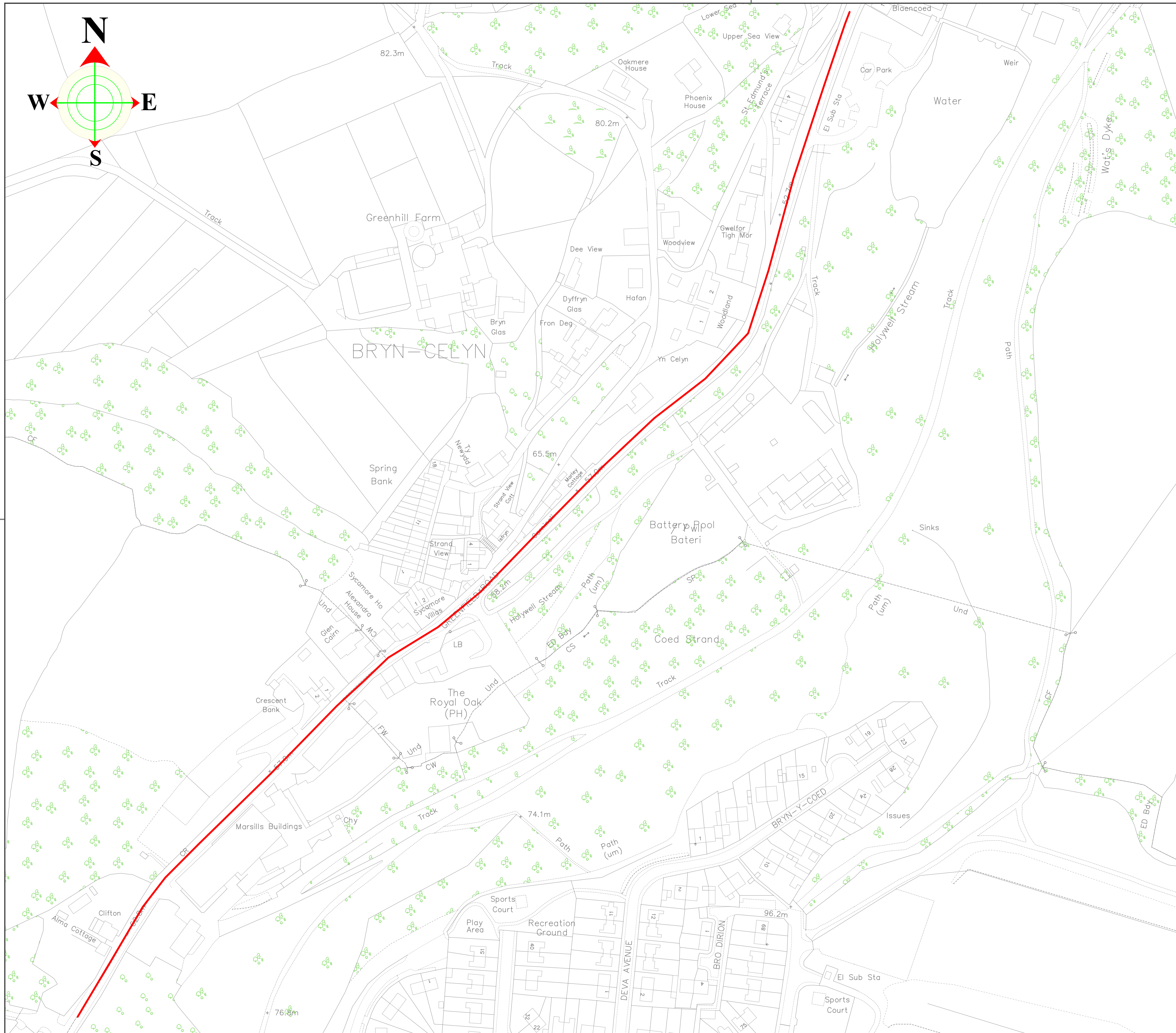

This map is reproduced from Ordnance Survey material with the permission of Ordnance Survey on behalf of the Controller of Her Majesty's Stationery Office. © Crown Copyright. Unauthorised reproduction infringes Crown Copyright and may lead to prosecution or civil proceedings. Licence number 100023386.Flintshire County Council, 2018.

PRELIMINARY	APPROVAL	CONSTRUCTION
-------------	----------	--------------

PH/Rev.	Revision Details	Rev.by	Chk.by	Date



Katie Wilby
Chief Officer (Streetscene and Transportation)
Prif Swyddog (Gwasanaethau Stryd a Thrafnidiaeth) **StreetScene** County Hall, Mold, CH7 6NF
Hwadd y Sir, Yr Wyddgrug, CH7 6NF

Project:
**Terfyn Cyflymder 30`mya
30mph Speed Limit**
B5121 Ffordd Maes Glas, Maes Glas
B5121 Greenfield Road, Greenfield

Flintshire County Council - Environment Directorate, County Hall 1, Mold CH7 6NF			
Contact Name:	Nick Williams	Telephone:	01352 704642
Drawn by:	Nick Williams	Fax No:	01352 70
Checked by:	Richard Flood	Date:	SEP 2023
Scales at A1:	Drawing No:	Phase/Rev:	
1:NTS	HT/23/Greenfield/201	P1	

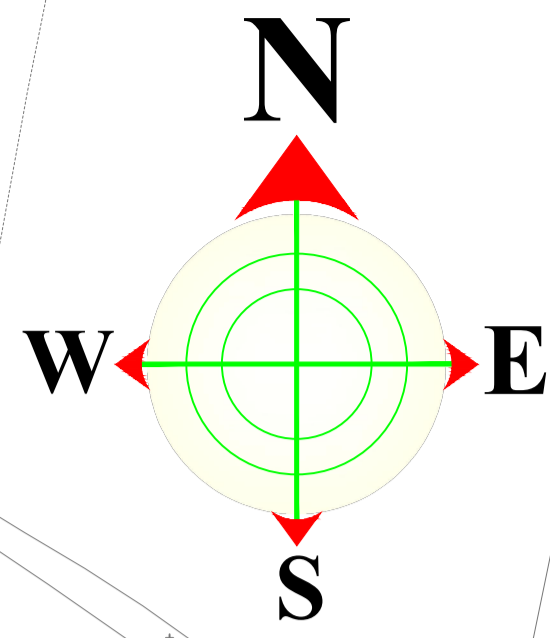

KEY

Terfyn Cyflymder
30`mya
30mph Speed limit

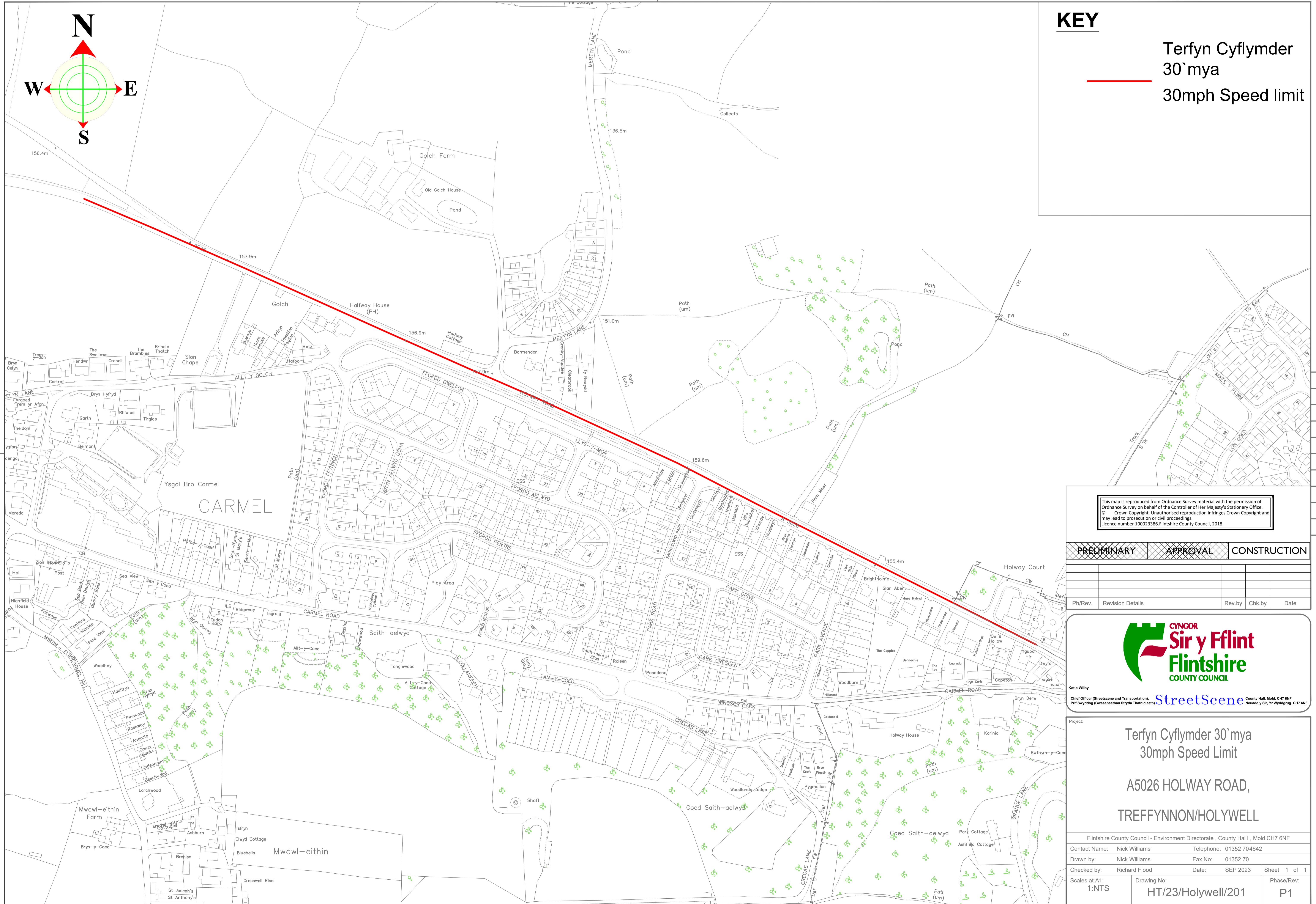

This map is reproduced from Ordnance Survey material with the permission of Ordnance Survey on behalf of the Controller of Her Majesty's Stationery Office. © Crown Copyright. Unauthorised reproduction infringes Crown Copyright and may lead to prosecution or civil proceedings. Licence number 100023386.Flintshire County Council, 2018.

PRELIMINARY	APPROVAL	CONSTRUCTION
-------------	----------	--------------

PH/Rev.	Revision Details	Rev.by	Chk.by	Date



StreetScene County Hall, Mold, CH7 6NF

Terfyn Cyflymder 30`mya
30mph Speed Limit
A5026 HOLWAY ROAD,
TREFFYNNON/HOLYWELL

Flintshire County Council - Environment Directorate , County Hal 1 , Mold CH7 6NF			
Contact Name:	Nick Williams	Telephone:	01352 704642
Drawn by:	Nick Williams	Fax No:	01352 70
Checked by:	Richard Flood	Date:	SEP 2023
Scales at A1:	1:NTS	Drawing No:	HT/23/Holywell/201
Phase/Rev:	P1	Sheet	1 of 1

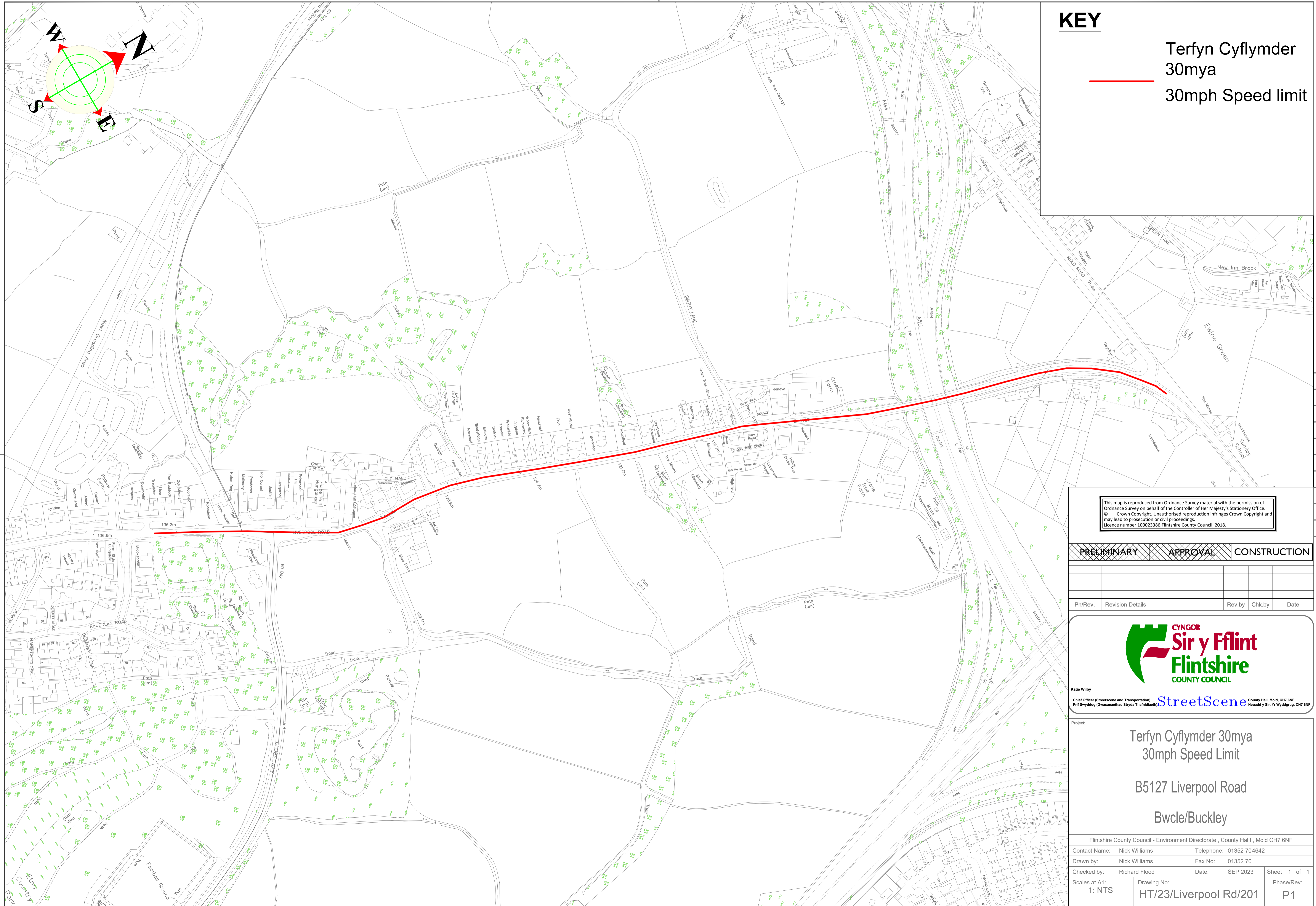

KEY

Terfyn Cyflymder
30mya
30mph Speed limit

This map is reproduced from Ordnance Survey material with the permission of Ordnance Survey on behalf of the Controller of Her Majesty's Stationery Office. © Crown Copyright. Unauthorised reproduction infringes Crown Copyright and may lead to prosecution or civil proceedings. Licence number 100023386. Flintshire County Council, 2018.

PRELIMINARY	APPROVAL	CONSTRUCTION
-------------	----------	--------------

PH/Rev.	Revision Details	Rev.by	Chk.by	Date



StreetScene County Hall, Mold, CH7 6NF
Haudd y Sir, Yr Wyddgrug, CH7 6NF

Terfyn Cyflymder 30mya
30mph Speed Limit
B5127 Liverpool Road
Bwcle/Buckley

Flintshire County Council - Environment Directorate, County Hall 1, Mold CH7 6NF			
Contact Name:	Nick Williams	Telephone:	01352 704642
Drawn by:	Nick Williams	Fax No:	01352 70
Checked by:	Richard Flood	Date:	SEP 2023
Scales at A1:	1: NTS	Drawing No:	HT/23/Liverpool Rd/201
Phase/Rev:	P1	Sheet	1 of 1

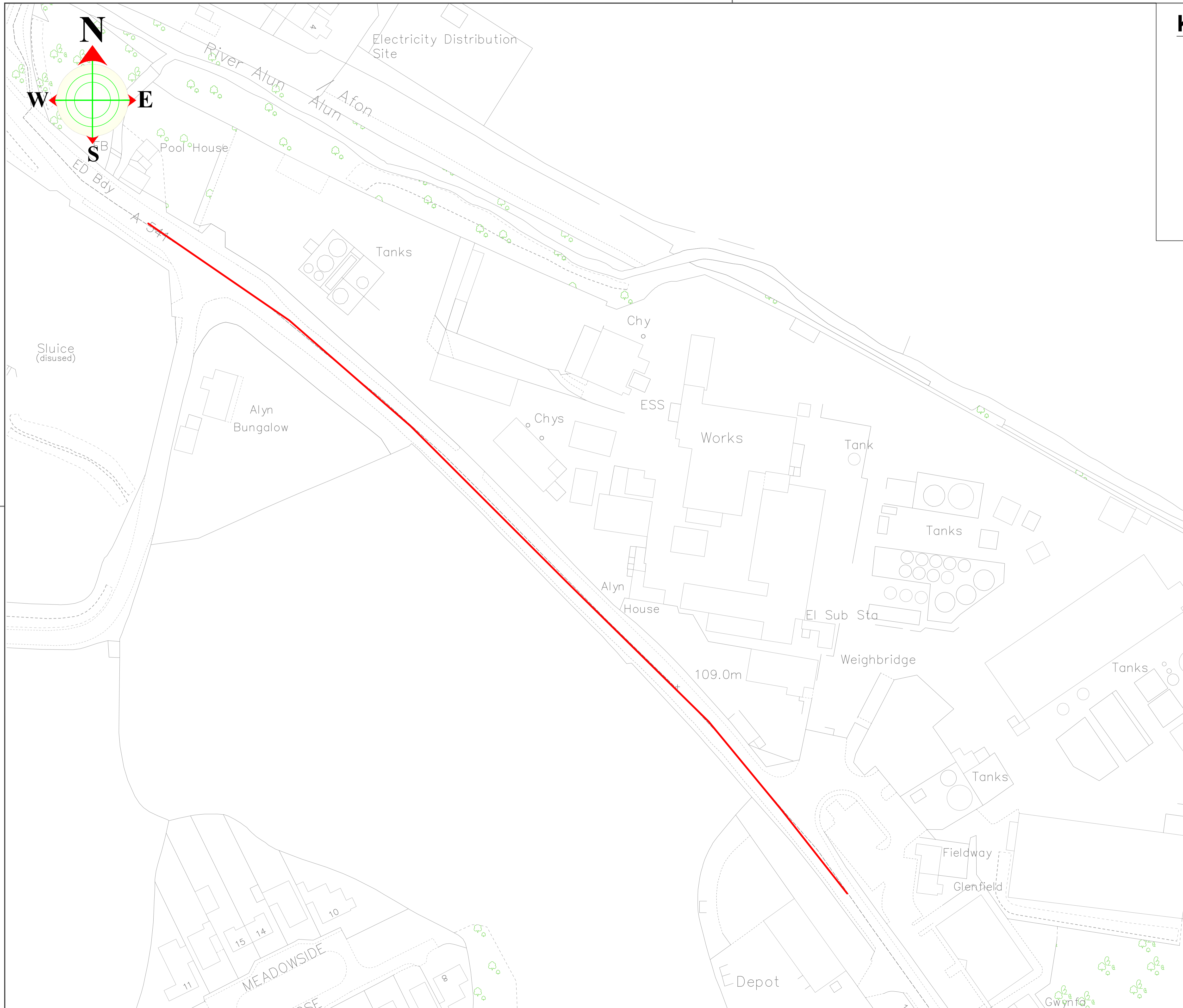

KEY

— Terfyn Cyflymder 30mya
 — 30mph Speed limit

This map is reproduced from Ordnance Survey material with the permission of Ordnance Survey on behalf of the Controller of Her Majesty's Stationery Office. © Crown Copyright. Unauthorised reproduction infringes Crown Copyright and may lead to prosecution or civil proceedings. Licence number 100023386. Flintshire County Council, 2018.

PH/Rev.	Revision Details	Rev.by	Chk.by	Date



StreetScene County Hall, Mold, CH7 6NF
 Hwaidd y Sir, Yr Wyddgrug, CH7 6NF

Terfyn Cyflymder 30mya
 30mph Speed Limit

A541 FFORDD DINBYCH, YR WYDDGRUG

A541 DENBIGH ROAD, MOLD

Flintshire County Council - Environment Directorate, County Hall 1, Mold CH7 6NF

Contact Name: Nick Williams Telephone: 01352 704642

Drawn by: Nick Williams Fax No: 01352 70

Checked by: Richard Flood Date: SEP 2023 Sheet 1 of 1

Scales at A1: 1: NTS	Drawing No: HT/23/MOLD/201	Phase/Rev: P1
-------------------------	-------------------------------	------------------

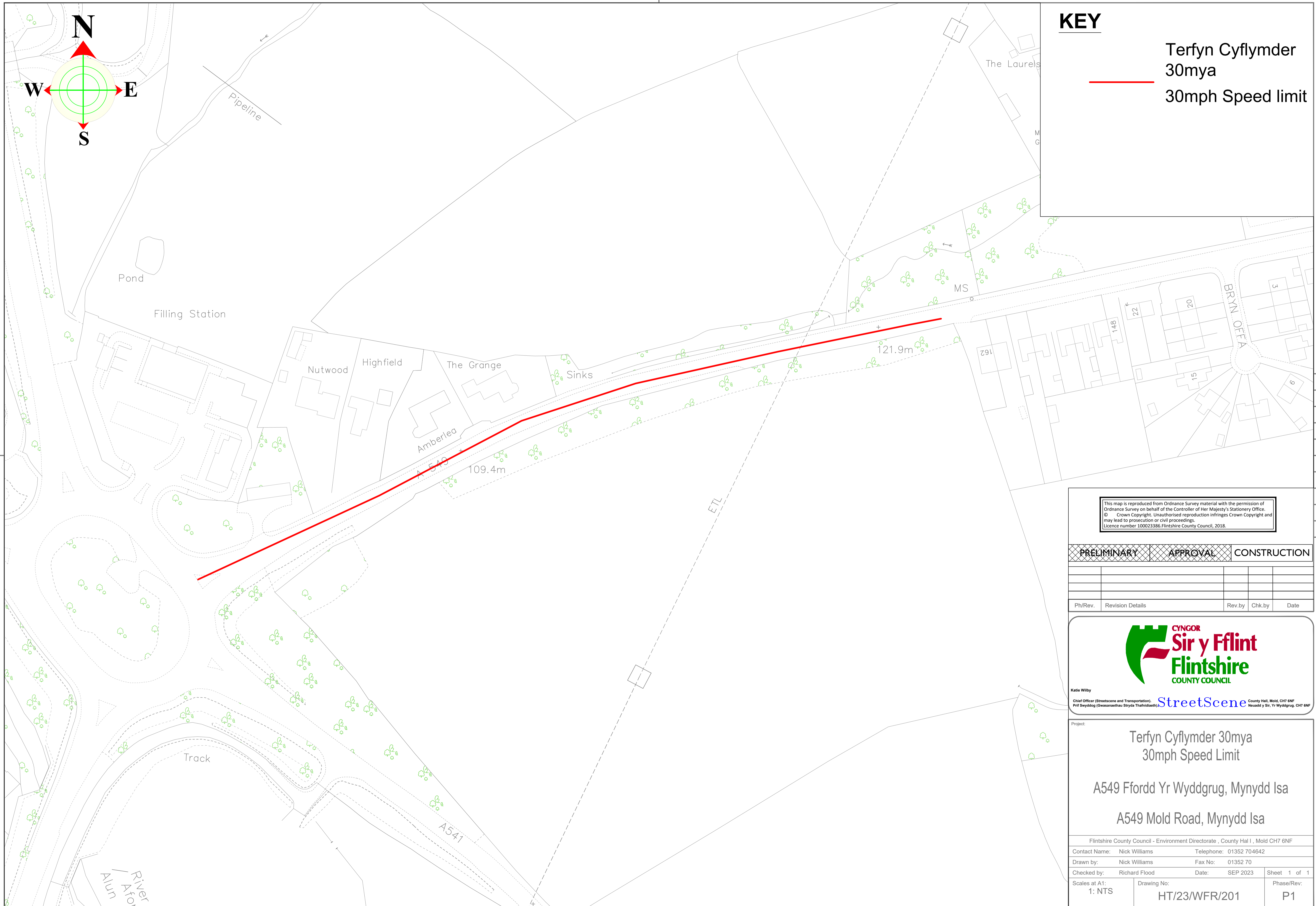

This map is reproduced from Ordnance Survey material with the permission of Ordnance Survey on behalf of the Controller of Her Majesty's Stationery Office. © Crown Copyright. Unauthorised reproduction infringes Crown Copyright and may lead to prosecution or civil proceedings. Licence number 100023386. Flintshire County Council, 2018.

PRELIMINARY	APPROVAL	CONSTRUCTION
-------------	----------	--------------

PH/Rev.	Revision Details	Rev.by	Chk.by	Date



Katie Wilby
 Chief Officer (Streetscene and Transportation)
 Prif Swyddog (Gwasanaethau Stryd a Trafnidwaeth)
 StreetScene
 County Hall, Mold, CH7 6NF
 Hwedd y Sir, Yr Wyddgrug, CH7 6NF

Project:
 Terfyn Cyflymder 30mya
 30mph Speed Limit
 A549 Ffordd Yr Wyddgrug, Mynydd Isa
 A549 Mold Road, Mynydd Isa

Flintshire County Council - Environment Directorate, County Hall 1, Mold CH7 6NF			
Contact Name:	Nick Williams	Telephone:	01352 704642
Drawn by:	Nick Williams	Fax No:	01352 70
Checked by:	Richard Flood	Date:	SEP 2023
Scales at A1:	1: NTS	Drawing No:	HT/23/WFR/201
Phase/Rev:	P1	Sheet	1 of 1

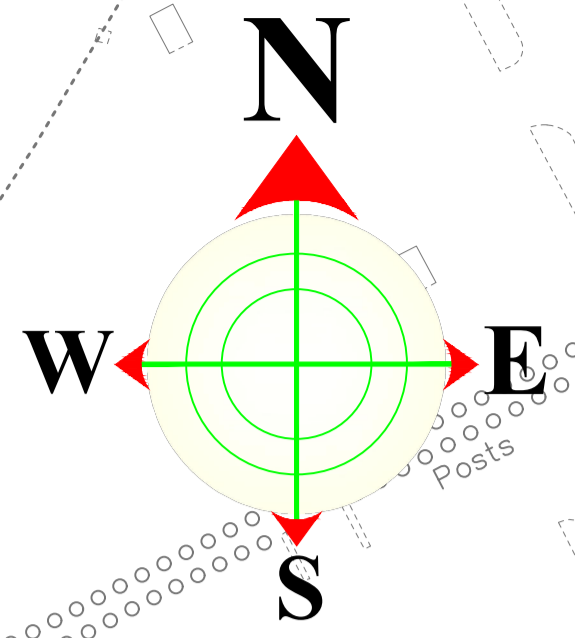

KEY

Terfyn Cyflymder
30`mya
30mph Speed limit

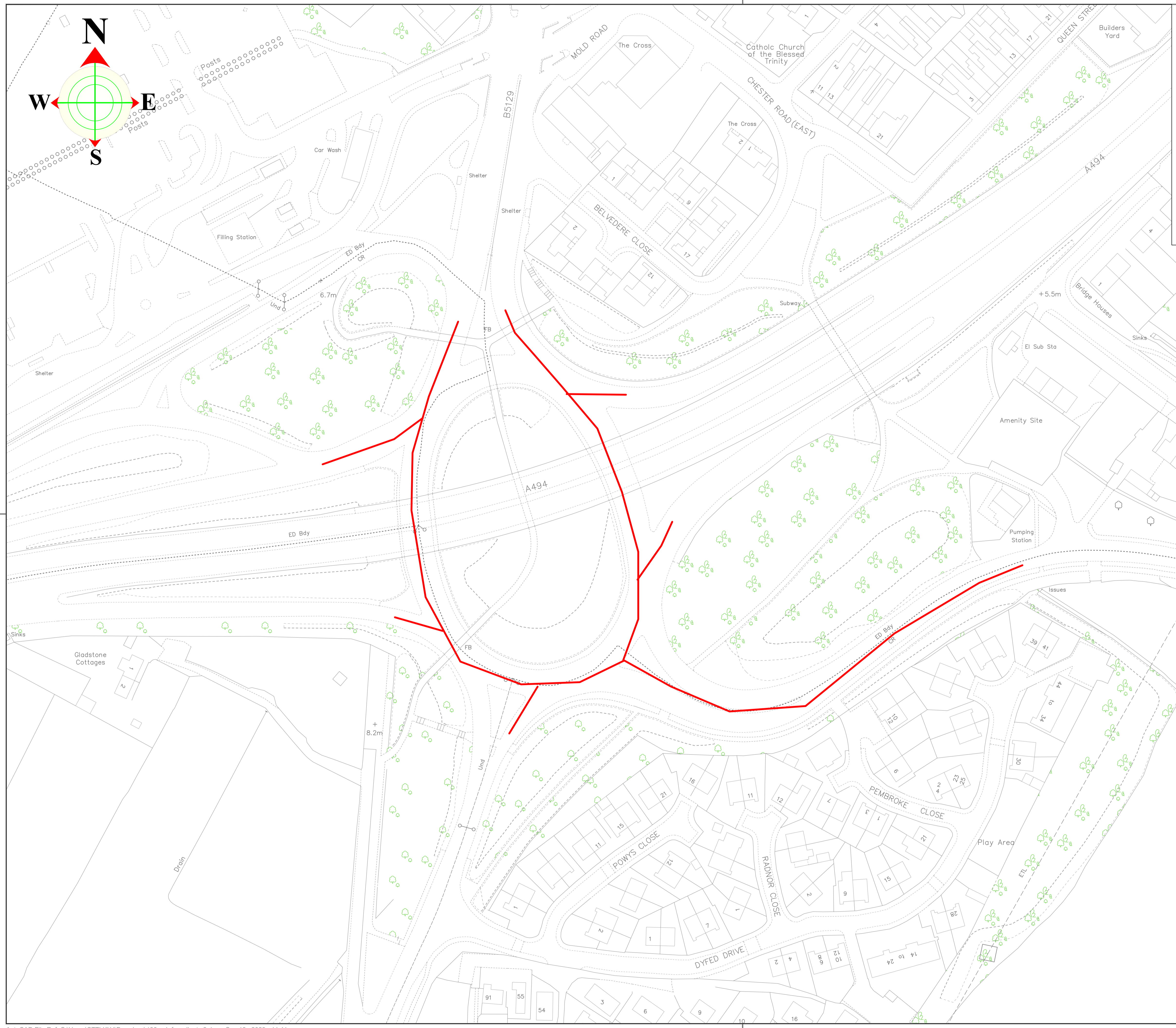

This map is reproduced from Ordnance Survey material with the permission of Ordnance Survey on behalf of the Controller of Her Majesty's Stationery Office. © Crown Copyright. Unauthorised reproduction infringes Crown Copyright and may lead to prosecution or civil proceedings. Licence number 100023386.Flintshire County Council, 2018.

PRELIMINARY	APPROVAL	CONSTRUCTION
-------------	----------	--------------

PH/Rev.	Revision Details	Rev.by	Chk.by	Date



StreetScene County Hall, Mold, CH7 6NF

Terfyn Cyflymder 30`mya
30mph Speed Limit

B5129 CHESTER ROAD WEST
B5129 CHESTER ROAD EAST

Flintshire County Council - Environment Directorate , County Hal 1 , Mold CH7 6NF			
Contact Name:	Nick Williams	Telephone:	01352 704642
Drawn by:	Nick Williams	Fax No:	01352 70
Checked by:	Richard Flood	Date:	SEP 2023
Scales at A1:	1:NTS	Drawing No:	HT/23/Q-Ferry/201
Phase/Rev:	P1	Sheet	1 of 1